

# SUNN 1017 LLC

## JORDAN ROAD SOLAR ENERGY SYSTEM

4516 JORDAN ROAD, TOWN OF SKANEATELES  
ONONDAGA COUNTY, NEW YORK

**Barton  
& Loguidice**

NYS CERTIFICATE # 0021642, 0020588, 0019903, 0019905, 0020336

**NOVEMBER 2024**  
**SITE PLAN DRAWINGS**

DRAWING INDEX	
SHEET NO.	SHEET TITLE
G001	COVER
G002	GENERAL NOTES, LEGEND, AND DRAWING INDEX
C001	EXISTING CONDITIONS AND DEMOLITION PLAN
C101	PRELIMINARY CIVIL SITE PLAN
C501	SITE DETAILS 1
C502	SITE DETAILS 2
C503	SITE DETAILS 3
C504	SITE DETAILS 4
C505	SITE DETAILS 5

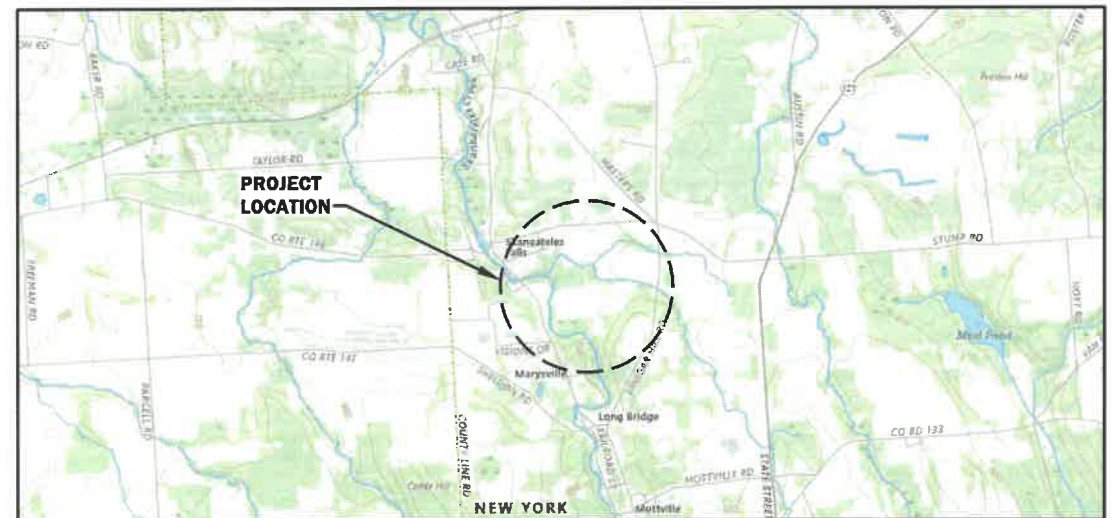

**PROJECT LOCATION MAP**

1 = 2000 FEET



Sheet Number  
**G001**  
Project Number  
2271.010.001

IT IS A VIOLATION OF THE NEW YORK STATE EDUCATION LAW, ARTICLE 145 § 7209 SPECIAL PROVISIONS, FOR ANY PERSON, UNLESS THEY ARE ACTING UNDER THE DIRECTION OF A LICENSED PROFESSIONAL ENGINEER, ARCHITECT, LANDSCAPE ARCHITECT, OR LAND SURVEYOR, TO ALTER ANY ITEM IN ANY WAY. IF AN ITEM BEARING THE STAMP OF A LICENSED PROFESSIONAL IS ALTERED, THE ALTERING PROFESSIONAL SHALL STAMP THE DOCUMENT AND INCLUDE THE NOTATION "ALTERED BY" FOLLOWED BY THEIR SIGNATURE, THE DATE OF SUCH ALTERATION, AND A SPECIFIC DESCRIPTION OF THE ALTERATION.

GENERAL NOTES:

- 1. THESE DRAWINGS AND SPECIFICATIONS, INCLUDING IDEAS, DESIGN AND ARRANGEMENTS REPRESENTED THEREBY ARE THE PROPERTY OF BARTON & LOGUIDICE, D.P.C. NO PART THEREOF SHALL BE COPIED, DISCLOSED TO OTHERS OR USED IN CONNECTION WITH ANY WORK OR PROJECT OTHER THAN THE SPECIFIED PROJECT FOR WHICH THEY HAVE BEEN PREPARED WITHOUT THE EXPRESS WRITTEN CONSENT OF BARTON & LOGUIDICE, D.P.C.
2. THE CONTRACTOR SHALL FAMILIARIZE HIMSELF/HERSELF WITH THE SITE AND LOCATE ALL UTILITIES IN THE FIELD AND REPORT ANY DISCREPANCIES TO THE OWNER'S REPRESENTATIVE.
3. PRIOR TO ANY DEMOLITION, CONTRACTOR SHALL NOTIFY OWNER'S REPRESENTATIVE AT LEAST 48-HOURS BEFORE WORK IS SCHEDULED TO BEGIN.
4. CONTRACTOR SHALL BE RESPONSIBLE FOR DISPOSING OF ALL DEBRIS OFF-SITE IN A SAFE MANNER. CONTRACTOR SHALL PROVIDE DOCUMENTATION OR LEGAL DISPOSAL MANIFEST TO OWNER'S REPRESENTATIVE.
5. PRIOR TO EXCAVATION, THE CONTRACTOR SHALL PROVIDE SIMILAR MARK-UP AS PER CODE NYS 53 BY FIELD VERIFYING ALL THOSE UTILITIES SO MARKED. COORDINATE WITH OWNER'S REPRESENTATIVE.
6. ALL AREAS DISTURBED BY CONSTRUCTION TO BE RESTORED TO PRE-CONSTRUCTION CONDITIONS OF EQUAL OR GREATER VALUE, IF NOT INDICATED OTHERWISE.
7. THE GENERAL CONTRACTOR SHALL BE RESPONSIBLE FOR THE UPKEEP OF ALL ON-SITE ROADS UTILIZED BY THE CONTRACTOR AND ITS SUBCONTRACTORS. SUCH MAINTENANCE SHALL INCLUDE THE APPLICATION OF WATER TO ADEQUATELY CONTROL DUST. THE USE OF CALCIUM CHLORIDE IS PROHIBITED. NO OFF-SITE TRACKING OF DIRT ONTO ROADWAYS WILL BE PERMITTED.
8. ALL EXISTING ROADS USED BY THE CONTRACTOR DURING CONSTRUCTION SHALL BE RESTORED TO THEIR ORIGINAL CONDITION OR BETTER. GRAVEL ROADS CONTAMINATED WITH SOIL SHALL BE TOPPED WITH A CLEAN STONE WEARING SURFACE APPROVED BY THE ENGINEER.
9. THE CONTRACTOR SHALL PROVIDE AS-BUILT RECORD INFORMATION ELECTRONICALLY INCLUDING, BUT NOT LIMITED TO, THE LOCATION AND ELEVATION OF THE FOLLOWING INFORMATION AS WELL AS ALL REQUIREMENTS OF THE SPECIFICATIONS
7.1. RECORD OF ALL UTILITIES ENCOUNTERED IN TRENCH EXCAVATION, INFORMATION SHALL INCLUDE DIAMETER OF UTILITY, DEPTH OF BURIAL AND LOCATION. INFORMATION SHALL BE KEPT CURRENT ON A WEEKLY BASIS.
7.2. DENOTE BENCH MARK REFERENCE POINTS USED.
7.3. RECORD DETAILS NOT SHOWN ON THE ORIGINAL CONTRACT DRAWINGS. ANY FIELD CHANGES OF DIMENSIONS AND DETAILS AND ALL CHANGES MADE BY CHANGE ORDER OF FIELD ORDER.
7.4. CERTIFICATE OF SUBSTANTIAL COMPLETION SHALL NOT BE ISSUED UNTIL ALL AS-BUILT INFORMATION IS ACCEPTABLE TO THE ENGINEER.
8. ALL CONTRACTOR STAGING AREAS AND ACCESS ROADS SHALL BE COORDINATED AND APPROVED BY THE OWNER/ENGINEER.

LAYOUT NOTES:

- 1. AFTER STAKEOUT, PRIOR TO ANY CLEARING, GRUBBING, EXCAVATION, OR GRADING, THE CONTRACTOR SHALL INSTALL TREE PROTECTION, AS SPECIFIED, FOR ALL TREES TO REMAIN.
2. COORDINATE UTILITY WORK WITH THE LOCATIONS AND FINAL GRADES OF ALL OTHER WORK. WHERE CONFLICTS OCCUR, NOTIFY THE OWNER'S REPRESENTATIVE PRIOR TO INSTALLATION OF UTILITIES AND MAKE ADJUSTMENTS AS REQUIRED. IF EXISTING OR NEW UTILITIES HAVE BEEN INSTALLED IN CONFLICT OF CURBS, PAVINGS, OR OTHER STRUCTURES AT DEPTHS TOO SHALLOW FOR PROPER COVER BENEATH FINAL NEW GRADES OR INCORRECT FINISH GRADE, THEY SHALL BE ADJUSTED OR REMOVED AND REPLACED AS NECESSARY WITHOUT EXTRA COMPENSATION.

GRADING AND DRAINAGE NOTES:

- 1. CONTRACTOR SHALL VERIFY LOCATION OF ALL UTILITIES IN THE FIELD. COORDINATE AND COMPLY WITH NEW YORK STATE CODE 53 REQUEST REQUIREMENTS.
2. THE CONTRACTOR SHALL PROTECT ALL EXISTING SITE AMENITIES NOT DESIGNATED FOR REMOVAL.
3. THE CONTRACTOR SHALL CHECK AND VERIFY ALL PROPOSED GRADES, DIMENSIONS, EXISTING CONDITIONS AND UTILITIES AND REPORT ANY DISCREPANCIES TO THE OWNER'S REPRESENTATIVE FOR HIS/HER DIRECTION BEFORE PROCEEDING WITH THE WORK.
4. THE USER OF THESE DRAWINGS IS CAUTIONED THAT UNDERGROUND UTILITIES AND FOUNDATIONS AS SHOWN ARE NOT GUARANTEED. NOR IS THERE ANY GUARANTEE THAT ALL EXISTING UTILITIES AND FOUNDATIONS, WHETHER ABANDONED OR FUNCTIONAL, ARE SHOWN ON THESE DRAWINGS.
5. THE CONTRACTOR SHALL EXERCISE EXTREME CARE WHEN WORKING NEAR EXISTING TREES.
6. ALL FINAL GRADING SHALL BE APPROVED BY THE OWNER'S REPRESENTATIVE PRIOR TO PLANTING, SEEDING, OR SODDING.
7. ALL GRADING WORK SHALL BE STAKED OUT USING GRADE STAKES.
8. ALL FILL MATERIAL SHALL BE FREE FROM ROOTS AND OTHER ORGANIC MATERIAL, TRASH AND FROZEN MATERIAL. NO STONES LARGER THAN 2" IN ANY DIMENSION SHALL BE PERMITTED.
9. THE CONTRACTOR SHALL CONFORM TO THE REQUIREMENTS OF OSHA, AND ANY OTHER AGENCY HAVING JURISDICTION WITH REGARD TO SAFETY PRECAUTIONS WITH TRENCHING OPERATIONS. THE REQUIREMENTS SET FORTH HEREIN ARE INTENDED TO SUPPLEMENT REQUIREMENTS ESTABLISHED BY OTHER AGENCIES. IN THE CASE OF A CONFLICT BETWEEN REQUIREMENTS OF OTHER JURISDICTIONAL AGENCIES AND THESE DOCUMENTS, THE MORE STRINGENT REQUIREMENT SHALL APPLY.
10. SHEETING, IF REQUIRED DURING CONSTRUCTION, IS CONSIDERED TO BE PART OF THIS CONTRACT AND SHALL BE PROVIDED AT NO ADDITIONAL COST TO THE OWNER.
11. ALL TRENCHES THROUGH PAVEMENT SHALL BE SAW CUT PRIOR TO EXCAVATION AND AGAIN PRIOR TO PAVEMENT RESTORATION.
12. CONTRACTOR SHALL ADJUST THE RIMS OF ALL MANHOLES, CATCH BASINS, VALVE BOXES AND OTHER UTILITY SITE STRUCTURES TO MEET FINISHED GRADE IN AREAS REQUIRING RE-PAVING OR RE-GRADING AS PART OF THE WORK, INCLUDING THOSE THAT MAY NOT BE SHOWN ON THE PLANS.
13. VOIDS LEFT BY UTILITY OR STRUCTURAL REMOVAL OR GRUBBING OPERATIONS SHALL BE BACKFILLED AND PROPERLY COMPACTED WITH STRUCTURAL FILL (NYS DOT ITEM 304.12) IN AREAS UNDER AND WITHIN 5 FEET HORIZONTALLY OF ALL STRUCTURES, BUILDINGS AND PAVEMENTS. IN GRASSED AREAS, VOIDS LEFT SHALL BE FILLED AND PROPERLY COMPACTED WITH SUITABLE ON-SITE OR IMPORTED EARTHEN BACKFILL. ALL DISTURBED AREAS SHALL BE RESTORED.
14. THE CONTRACTOR SHALL DEWATER ALL EXCAVATIONS TO PREVENT THE INTRODUCTION OF GROUNDWATER INTO THE TRENCHES/EXCAVATIONS. PROVIDE ALL EQUIPMENT NECESSARY TO MAINTAIN THE GROUNDWATER LEVEL AS NECESSARY.
15. THE CONTRACTOR SHALL PLACE A MINIMUM OF 4 INCHES OF CLEANED SCREENED TOPSOIL IN ALL DISTURBED AREAS PRIOR TO SEEDING.

REMOVAL NOTES:

- 1. PRIOR TO SUBMITTING THE BID, IT IS THE CONTRACTOR'S RESPONSIBILITY TO VISIT THE SITE AND FAMILIARIZE HIMSELF/HERSELF WITH THE SITE CONDITIONS AND EXISTING CONDITIONS TO BE REMOVED.
2. THE CONTRACTOR SHALL VERIFY EXISTING CONDITIONS AND DIMENSIONS IN THE FIELD BEFORE COMMENCING WITH ANY FABRICATION, ORDERING OF MATERIAL, OR PERFORMING WORK. THE CONTRACTOR SHALL NOTIFY THE OWNER'S REPRESENTATIVE OF ANY CONDITIONS OR DIMENSIONS THAT WOULD HAMPER THE PERFORMANCE OF THE WORK IN ACCORDANCE WITH THE CONTRACT DRAWINGS AND SPECIFICATIONS.
3. THE LOCATIONS OF EXISTING UTILITIES, WATER, SEWERS, AND DRAINAGE STRUCTURES HAVE BEEN INDICATED BASED ON THE BEST AVAILABLE INFORMATION PROVIDED BY THE SURVEYOR. IT IS POSSIBLE THAT THE ACTUAL SUBSURFACE UTILITIES AND PIPING MAY VARY FROM THAT INDICATED. THEREFORE, PRIOR TO STARTING WORK IN ANY AREA, THE CONTRACTOR SHALL TAKE THE NECESSARY STEPS TO DETERMINE THE LOCATIONS OF ALL EXISTING UNDERGROUND PIPING, CONDUIT AND STRUCTURES. HE/SHE SHALL CARRY OUT HIS/HER OPERATIONS IN SUCH A MANNER AS TO PREVENT INTERFERENCE WITH LINES WHICH ARE TO REMAIN ALONE. ANY PIPE OR CONDUIT DISTURBED IN THE COURSE OF CONTRACT SHALL BE REPAIRED BY THE CONTRACTOR AT NO EXTRA COST TO THE OWNER.
4. ALL EXISTING UTILITIES SHALL BE MARKED OUT BY THE CONTRACTOR PRIOR TO ANY CONSTRUCTION ACTIVITIES.
5. ALL ADJACENT AREAS OUTSIDE OF THE DISTURBANCE LIMIT LINE AND DISTURBED DURING THE COURSE OF CONSTRUCTION, SHALL BE REPAIRED TO NEW CONDITION BY THE CONTRACTOR AT NO ADDITIONAL COST TO THE OWNER.
6. ALL AREAS NOT COVERED BY IMPERVIOUS SURFACE AND DAMAGED DURING CONSTRUCTION SHALL BE TOPSOILED AND EITHER SEEDDED OR SODDED IN ACCORDANCE WITH THE PLANS AND SPECS.
7. PRIOR TO THE START OF EXCAVATION FOR NEW DRAINAGE, THE CONTRACTOR SHALL VERIFY THE LOCATION OF EXISTING UNDERGROUND UTILITIES WITHIN THE AREA OF WORK.
8. WHERE CONSTRUCTION CROSSES OR IS ADJACENT TO EXISTING UTILITY LINES (FUEL, WATER, GAS, TELEPHONE, ELECTRIC, COMMUNICATION, ETC.) THE CONTRACTOR SHALL CAREFULLY HAND EXCAVATE SO AS TO LOCATE, MARK AND PROTECT THE UTILITY LINES AGAINST DISTURBANCE OR DAMAGE BY PROVIDING ADEQUATE SUPPORT AND PROTECTION AS APPROVED BY THE OWNER'S REPRESENTATIVE. THE CONTRACTOR SHALL REPAIR ANY POWER OR COMMUNICATION INTERRUPTION IMMEDIATELY, AT NO ADDITIONAL COST TO OWNER.
9. WHERE INTERFERENCE WITH OTHER UTILITIES OR CONSTRUCTION ARE ENCOUNTERED DURING CONSTRUCTION OF NEW UTILITY LINES, THE CONTRACTOR MAY ADJUST THE ALIGNMENT OR INVERT ELEVATIONS OF THAT SYSTEM ONLY AT THE DIRECTION OF THE OWNER'S REPRESENTATIVE.
10. THE CONTRACTOR SHALL ACCEPT FULL RESPONSIBILITY FOR THE PROPER PROTECTION OF EXISTING STRUCTURES WHICH ARE DESIGNATED TO REMAIN DURING CONSTRUCTION AND THE LIFE OF THE CONTRACT. ANY STRUCTURES FOUND TO BE DAMAGED DURING THE PROJECT DURATION SHALL BE REPAIRED OR REPLACED AT THE OWNER'S REPRESENTATIVE'S DISCRETION TO THE COMPLETE SATISFACTION OF THE OWNER'S REPRESENTATIVE AND AT THE CONTRACTOR'S FULL EXPENSE.
11. THE CONTRACTOR SHALL EXERCISE EXTREME CAUTION WHEN WORKING ADJACENT TO ACTIVE POWER AND COMMUNICATION LINES TO PREVENT DAMAGE TO THESE LINES. THE CONTRACTOR SHALL HAND EXCAVATE TEST PITS TO EXPOSE THOSE LINES PRIOR TO PERFORMING ANY OTHER EXCAVATION WORK IN THE AREA. THE CONTRACTOR SHALL REPAIR AT HIS/HER EXPENSE, ANY POWER OR COMMUNICATION INTERRUPTION IMMEDIATELY.
12. APPLY EROSION CONTROL MATTING TO ALL STEEP SLOPES, DISTURBED AND NEW SLOPES, 4:1 AND GREATER, UNTIL SLOPES ARE STABILIZED.

SURVEY NOTES:

- 1. NORTH ARROW, BEARINGS AND COORDINATES ARE REFERENCED TO NORTH AMERICAN DATUM (NAD) OF 1983 PROJECTED ONTO THE NEW YORK STATE PLANE COORDINATE SYSTEM (CENTRAL ZONE) AND ARE BASED UPON GPS OBSERVATIONS UTILIZING THE NEW YORK STATE CORS NETWORK.
2. CONTOURS SHOWN HEREON ARE BASED UPON LIDAR MAPPING FROM THE NEW YORK STATE ORTHOIMAGERY PROGRAM. AWLS HAS PERFORMED SPOT ELEVATION CHECKS THROUGHOUT THE PROJECT AREA. ACCORDING TO GDB GEOSPATIAL WHO PROVIDED THE LIDAR MAPPING, "THE LIDAR SHOULD BE ACCURATE TO AT LEAST HALF THE CONTOUR INTERVAL AT A 95 PERCENT CONFIDENCE LEVEL".
3. A FIELD SURVEY HAS NOT BEEN CONDUCTED. UNDERGROUND FACILITIES AND STRUCTURES SHOWN HEREON WERE TAKEN FROM DATA OBTAINED FROM PREVIOUS MAPS AND RECORD DRAWINGS. THERE MAY BE OTHER UNDERGROUND UTILITIES, THE EXISTENCE OF WHICH ARE NOT KNOWN OR CERTIFIED BY THE UNDERSIGNED. THE SIZE AND LOCATION OF ALL UNDERGROUND UTILITIES AND STRUCTURES MUST BE VERIFIED BY THE APPROPRIATE AUTHORITIES. THE UNDERGROUND FACILITIES PROTECTIVE ORGANIZATION MUST BE NOTIFIED PRIOR TO CONDUCTING TEST BORINGS, EXCAVATION AND CONSTRUCTION. CONTRACTOR SHALL FIELD VERIFY ALL EXISTING CONDITIONS PRIOR TO BID. NO ALLOWANCE WILL BE MADE FOR ADDITIONAL COSTS DUE TO CONTRACTOR'S FAILURE TO VERIFY EXISTING CONDITIONS.
4. THE CONTRACTOR SHALL LOCATE, MARK, SAFEGUARD AND PRESERVE ALL SURVEY MARKERS AND RIGHT-OF-WAY MARKERS IN THE AREA OF CONSTRUCTION. ANY IRON PINS, MONUMENTS OR OTHER ITEMS DEFINING PROPERTY LINES WHICH ARE DISTURBED BY CONSTRUCTION OPERATIONS SHALL BE PROPERLY TIED AND ACCURATELY RESET BY A NYS LICENSED SURVEYOR UPON COMPLETION OF THE WORK.

EROSION AND SEDIMENT CONTROL NOTES:

- 1. ALL EROSION AND SEDIMENT CONTROL MEASURES SHALL BE INSTALLED IN ACCORDANCE WITH BEST MANAGEMENT PRACTICES MANUAL FOR EROSION AND SEDIMENT CONTROL AND THE STANDARDS FOR NEW YORK STATE DEPARTMENT OF ENVIRONMENTAL CONSERVATION AND WILL BE INSTALLED IN PROPER SEQUENCE & MAINTAINED UNTIL PERMANENT STABILIZATION IS ESTABLISHED.
2. TIMELY MAINTENANCE OF SEDIMENT CONTROL STRUCTURES IS THE RESPONSIBILITY OF THE CONTRACTOR. ALL STRUCTURES SHALL BE MAINTAINED IN GOOD WORKING ORDER AT ALL TIMES. THE SEDIMENT LEVEL IN ALL SEDIMENT TRAPS SHALL BE CLOSELY MONITORED AND SEDIMENT REMOVED PROMPTLY WHEN MAXIMUM LEVELS ARE REACHED OR AS ORDERED BY THE OWNER'S REPRESENTATIVE. ALL SEDIMENT CONTROL STRUCTURES SHALL BE INSPECTED ON A REGULAR BASIS, AND AFTER EACH HEAVY RAIN TO INSURE PROPER OPERATION AS DESIGNED. AN INSPECTION SCHEDULE SHALL BE SET FORTH PRIOR TO THE START OF CONSTRUCTION.
3. THE LOCATIONS AND THE INSTALLATION TIMES OF THE SEDIMENT STANDARDS SHALL BE AS ORDERED BY THE OWNER'S REPRESENTATIVE, AND IN ACCORDANCE WITH THE STANDARDS SET FORTH IN THE SWPPP.
4. ALL TOPSOIL NOT TO BE USED FOR FINAL GRADING SHALL BE PLACED IN A STABILIZED STOCKPILE OR FILL AREA. STOCKPILED TOPSOIL TO BE TEMPORARILY SEEDDED & MULCHED WITHIN 14-DAYS.
5. STOCKPILES ARE NOT TO BE LOCATED WITHIN 50-FEET OF A FLOOD PLAIN, SLOPE, ROADWAY, OR DRAINAGE FACILITY. THE BASE OF ALL STOCKPILES SHOULD BE CONTAINED BY A HAY BALE BARRIER OR SILT FENCE.
6. ANY DISTURBED AREA THAT WILL BE LEFT EXPOSED FOR MORE THAN TWO WEEKS (14 DAYS) AND NOT SUBJECT TO CONSTRUCTION TRAFFIC SHALL IMMEDIATELY RECEIVE A TEMPORARY SEEDING AND MULCHING. IF THE SEASON PROHIBITS TEMPORARY SEEDING, THE DISTURBED AREA WILL BE MULCHED WITH SALT HAY OR EQUIVALENT AND BOUND IN ACCORDANCE WITH THE N.Y. STANDARDS (i.e. PEG AND TWINE, MULCH NETTING, OR LIQUID MULCH BINDER).
7. STABILIZATION SPECIFICATIONS
A. TEMPORARY SEEDING AND MULCHING:
LIME-90 LBS/1,000SF GROUND LIMESTONE
FERTILIZER-11 LBS./1000SF 10-20-10 OR EQUIVALENT WORKED INTO SOIL A MINIMUM OF 4".
SEED-PERENNIAL RYEGRASS 40 LBS/ACRE (1 LB./1000SF) PLANTED BETWEEN MARCH 1-MAY 15 OR BETWEEN AUG. 15-OCT. 1.
MULCH-SALT HAY OR SMALL GRAIN STRAW AT A RATE OF 70-90 LBS./1000SF TO BE APPLIED ACCORDING TO N.Y. STANDARDS. MULCH SHALL BE SECURED BY APPROVED METHODS (I.E. PEG AND TWINE, MULCH NETTING, OR LIQUID MULCH BINDING).
8. THE SITE AT ALL TIMES MUST BE MAINTAINED SUCH THAT ALL STORMWATER RUNOFF IS DIVERTED TO SOIL EROSION AND SEDIMENT CONTROL FACILITIES.
9. SOIL EROSION AND SEDIMENT CONTROL MEASURES WILL BE INSPECTED AND MAINTAINED ON A DAILY BASIS, INCLUDING BEFORE AND AFTER EVERY STORM EVENT.
10. MAXIMUM SIDE SLOPES OF ALL EXPOSED SURFACES SHALL NOT EXCEED 3:1 UNLESS OTHERWISE APPROVED BY THE OWNER'S REPRESENTATIVE.
11. DUST SHALL BE CONTROLLED VIA THE APPLICATION OF WATER. THE USE OF CALCIUM CHLORIDE IS PROHIBITED.
12. ALL SOIL WASHED, DROPPED, SPILLED OR TRACKED OUTSIDE THE LIMIT OF DISTURBANCE OR ONTO PUBLIC RIGHT-OF-WAYS, WILL BE REMOVED IMMEDIATELY. PAVED ROADWAYS MUST BE KEPT CLEAN AT ALL TIMES DURING THE COURSE OF THE PROJECT.
13. STORM DRAINAGE OUTLETS WILL BE STABILIZED, AS REQUIRED, BEFORE DISCHARGE POINTS ARE OPERATIONAL.
14. ALL DEWATERING OPERATIONS MUST DISCHARGE DIRECTLY INTO A SEDIMENT CONTROL DEVICE.
15. TREES TO REMAIN AFTER CONSTRUCTION ARE TO BE PROTECTED WITH A SUITABLE FENCE INSTALLED AT THE DRIP LINE OR BEYOND.
16. SEDIMENT AND EROSION CONTROL STRUCTURES SHALL BE REMOVED AND THE AREA STABILIZED WHEN THE DRAINAGE AREA HAS BEEN PROPERLY STABILIZED BY PERMANENT MEASURES.
17. ACCESS MATTING TO BE PLACED IN ALL WETLAND AREAS FOR ACCESS BY CONSTRUCTION EQUIPMENT OF ANY TYPE. ACCESS MATTING SHOWN INDICATES LOCATIONS WHERE MATTING WILL BE PLACED FOR THE DURATION OF CONSTRUCTION.
18. LEVEL SPREADER SHALL BE INSTALLED IN ACCORDANCE WITH NEW YORK STANDARDS AND SPECIFICATIONS FOR EROSION AND SEDIMENT CONTROL.

SOIL DATA\*

Table with 7 columns: SOIL MAP UNIT SYMBOL, MAP UNIT NAME, ACRES IN LIMITS OF DISTURBANCE, PERCENT OF AREA OF DISTURBANCE, FARMLAND CLASSIFICATION, HYDROLOGIC SOIL GROUP. Rows include: AwC AURORA SILT LOAM, 6 TO 12 PERCENT SLOPES (0.86 ACRES, 1.5%, FARMLAND OF STATEWIDE IMPORTANCE, D); AXE AURORA-FARMINGTON-ROCK OUTCROP ASSOCIATION, STEEP (3.95 ACRES, 6.9%, NOT PRIME FARMLAND, D); C1B CAZENOVIA SILT LOAM, 2 TO 8 PERCENT SLOPES (40.19 ACRES, 69.7%, ALL AREAS ARE PRIME FARMLAND, C); C1C CAZENOVIA SILT LOAM, 8 TO 15 PERCENT SLOPES (3.85 ACRES, 6.7%, FARMLAND OF STATEWIDE IMPORTANCE, C); FL FLUVAQUENTS, FREQUENTLY FLOODED (1.11 ACRES, 1.9%, NOT PRIME FARMLAND, A/D); HTE HONEOYE, LANSING, AND ONTARIO SOILS, 25 TO 35 PERCENT SLOPES (0.24 ACRES, 0.4%, NOT PRIME FARMLAND, B); HwB HOWARD GRAVELLY FINE SANDY LOAM, 3 TO 8 PERCENT SLOPES (0.00 ACRES, 0.0%, ALL AREAS ARE PRIME FARMLAND, A); ML MADE LAND (3.76 ACRES, 6.5%, NOT PRIME FARMLAND, C); MwD MOHAWK SILT LOAM, 15 TO 25 PERCENT SLOPES (0.26 ACRES, 0.4%, NOT PRIME FARMLAND, C); OvA OVID SILT LOAM, 0 TO 3 PERCENT SLOPES (2.34 ACRES, 4.1%, PRIME FARMLAND IF DRAINED, C/D); PHD PALMYRA AND HOWARD SOILS, HILLY (0.00 ACRES, 0.0%, NOT PRIME FARMLAND, A); Te TEEL SILT LOAM (1.10 ACRES, 1.9%, ALL AREAS ARE PRIME FARMLAND, B/D); WcB WASSAIC SILT LOAM, 0 TO 8 PERCENT SLOPES (0.00 ACRES, 0.0%, ALL AREAS ARE PRIME FARMLAND, C).

\*REFERENCE: U.S. DEPARTMENT OF AGRICULTURAL NATURAL RESOURCES CONSERVATION SERVICE (NRCS) SOIL SURVEY GEOGRAPHIC (SSURGO) DATABASE ON WEB SOIL SURVEY.

PROJECT DATA

PARCEL INFORMATION

Table with 2 columns: Field Name, Value. Fields include: APPLICANT (I.E., OWNER, DEVELOPER, OPERATOR) SUNN LLC; PARCEL ADDRESS 4516 JORDAN ROAD, SKANEATELES, NY 13152; TAX NUMBER(S) 018.-04-31.0/1 & 018.-04-29.1; GPS COORDINATES 42°59'23.87" N, 76°26'45.14" W; PARCEL AREA ±117.4 ACRES; DISTURBED AREA/WORK LIMITS ±56.9 ACRES; EQUIPMENT PAD AREA ±660 SF EACH (5 TOTAL); STAGING AREA ±13,230 SF; LIMITS OF CONSTRUCTION ±57.7 ACRES.

ZONING INFORMATION

Table with 2 columns: Field Name, Value. Fields include: CODE APPLIED TOWN OF SKANEATELES; ZONING DISTRICT INDUSTRIAL/RESEARCH/OFFICE DISTRICT - IRO RURAL RESIDENTIAL DISTRICT - RR; PROPOSED USE COMMERCIAL SOLAR ENERGY SYSTEM; MIN. LOT AREA 20 ACRES ±117.4 ACRES; MAX. HEIGHT/PROJECTION 15' <15' AT MAX. TILT; MAX. SOLAR ARRAY PERCENT LOT AREA 25% ±36%; SETBACKS: MIN. 100' FRONT SETBACK 100 FEET; MIN. 100' SIDE SETBACK 100 FEET; MIN. 100' REAR SETBACK 100 FEET.

EXISTING CONDITIONS LEGEND

- - - - -410- MAJOR CONTOURS
- - - - - MINOR CONTOURS
- - - - - PARCEL BOUNDARY
- - - - - EXISTING UTILITY POLE
- - - - - EXISTING OVERHEAD UTILITIES
- - - - - FENCE
- - - - - DELINEATED WETLAND BOUNDARY
- - - - - DELINEATED STREAM CENTERLINE
- - - - - 100' WATERBODIES SETBACK
- - - - - EXISTING UNPAVED ROAD
- - - - - EXISTING PAVED ROAD
- - - - - SOIL TYPE BOUNDARY
- - - - - SETBACK LINE
- - - - - APPROXIMATE ZONING BOUNDARY

PROPOSED LEGEND

- - - - - PROJECT AREA
- - - - - PILE-DRIVEN AGRICULTURAL FENCE
- - - - - BALLASTED AGRICULTURAL FENCE
- - - - - UTILITY POLE
- - - - - OVERHEAD UTILITIES
- - - - - ABOVE GROUND UTILITIES
- - - - - UNDERGROUND UTILITIES
- - - - - LIMITED USE PERVIOUS ACCESS ROAD
- - - - - CONCRETE ELECTRICAL EQUIPMENT PAD
- - - - - STABILIZED CONSTRUCTION ENTRANCE
- - - - - SOLAR PANELS IN ARRAY #1
- - - - - SOLAR PANELS IN ARRAY #2
- - - - - SOLAR PANELS IN ARRAY #3
- - - - - SILT FENCE / SILT SOCK
- - - - - BRUSH CLEARING LINE
- - - - - DIVERSION SWALE
- - - - - LIMITS OF CONSTRUCTION
- - - - - STONE CHECK DAM
- - - - - FLOW DIFFUSER
- - - - - LEVEL SPREADERS
- - - - - STAGING AREA
- - - - - LIMITS OF CLEARING

REVIEW ONLY NOT FOR CONSTRUCTION

IT IS A VIOLATION OF THE NEW YORK STATE EDUCATION LAW, ARTICLE 145 § 2709 SPECIAL PROVISIONS, FOR ANY PERSON, UNLESS THEY ARE ACTING UNDER THE DIRECTION OF A LICENSED PROFESSIONAL ENGINEER, ARCHITECT, LANDSCAPE ARCHITECT, OR LAND SURVEYOR, TO ALTER AN ITEM IN ANY WAY. IF AN ITEM BEARING THE STAMP OF A LICENSED PROFESSIONAL IS ALTERED, THE ALTERING PROFESSIONAL SHALL STAMP THE DOCUMENT AND INCLUDE THE NOTATION "ALTERED BY" FOLLOWED BY THE LICENSE NUMBER, THE DATE OF SUCH ALTERATION, AND A SPECIFIC DESCRIPTION OF THE ALTERATION.

Table with 2 columns: REVISIONS, Description. Includes a table for tracking revisions.

ONONDAGA COUNTY, NEW YORK

JORDAN ROAD SOLAR ENERGY SYSTEM

GENERAL NOTES, LEGEND, AND DRAWING INDEX

B&L logo and contact information: 443 Electronics Parkway, Liverpool, NY 13088. Barton & Loguidice, D.P.C.

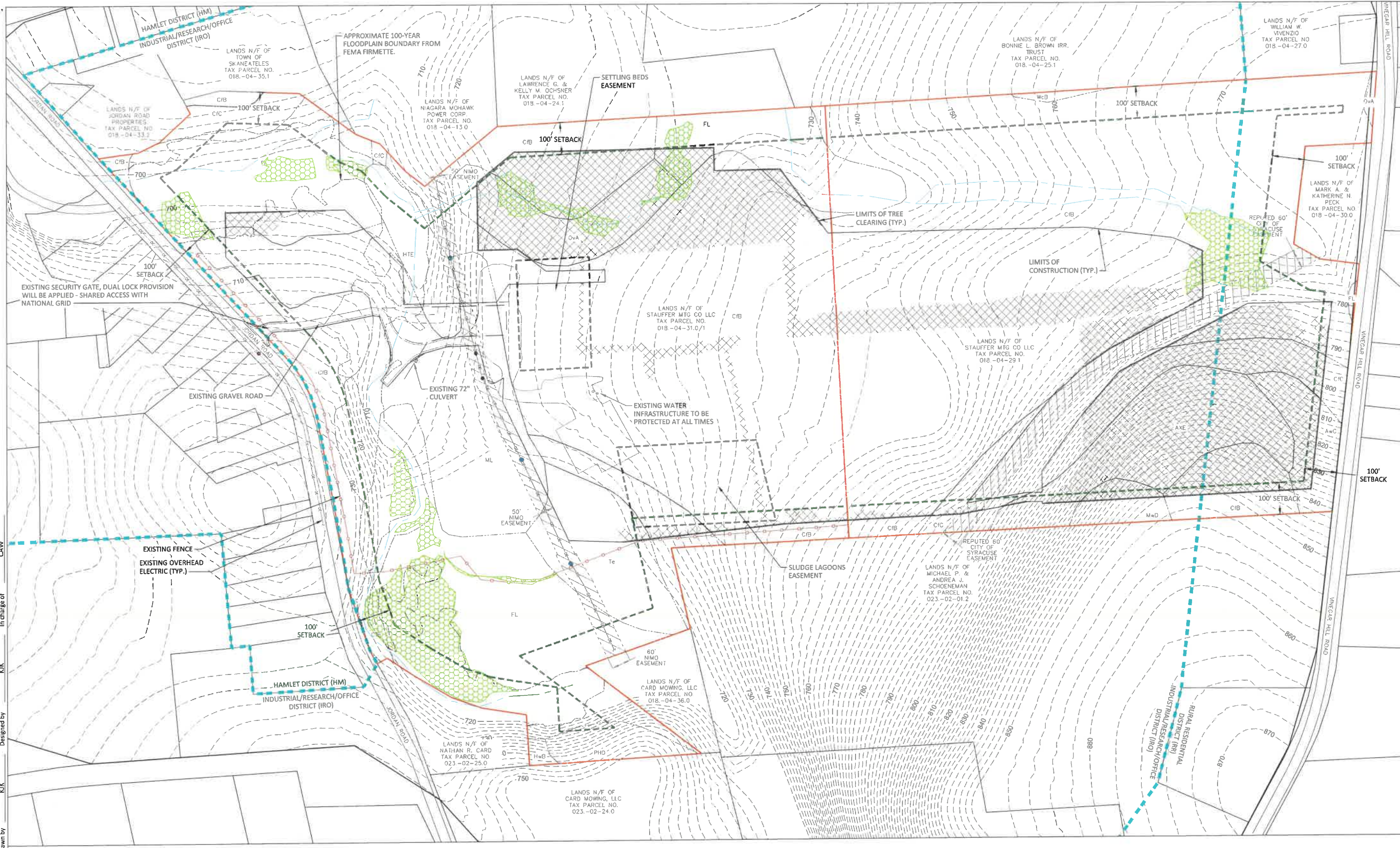

Table with 2 columns: Field Name, Value. Fields include: Date NOVEMBER 2024; Scale AS SHOWN; Sheet Number G002; Project Number 2271.010.001.

Checked by: R&M, Drawn by: KJK, Designed by: KJK, In charge of: CAW, Plotfile: Nov 26, 2024 - 4:18PM, I:\Projects\2200\2271.010.001\G02 General Notes.dwg, By: hickite, Project: 2271.010.001

Plotfile: Nov 25, 2024 - 4:18PM  
 i:\Projects\2271.010.001\2271.010.001\_Site\_Layout\_Sheets.dwg

Checked by: RLM  
 Drawn by: KJK  
 Designed by: KJK  
 In charge of: CAW



IT IS A VIOLATION OF THE NEW YORK STATE EDUCATION LAW, ARTICLE 145 §7209 SPECIAL PROVISIONS, FOR ANY PERSON, UNLESS THEY ARE ACTING UNDER THE DIRECTION OF A LICENSED PROFESSIONAL ENGINEER, ARCHITECT, LANDSCAPE ARCHITECT, OR LAND SURVEYOR, TO ALTER AN ITEM IN ANY WAY. IF AN ITEM BEARING THE STAMP OF A LICENSED PROFESSIONAL IS ALTERED, THE ALTERING PROFESSIONAL SHALL STAMP THE DOCUMENT AND INCLUDE THE NOTATION "ALTERED BY" FOLLOWED BY THEIR SIGNATURE, THE DATE OF SUCH ALTERATION, AND A SPECIFIC DESCRIPTION OF THE ALTERATION.

REVISIONS

SUNN LLC  
 JORDAN ROAD SOLAR ENERGY SYSTEM  
 ONONDAGA COUNTY, NEW YORK  
 TOWN OF SKANEATELES

**B&L**  
 443 Electronics Parkway  
 Liverpool, NY 13088  
**Barton & Loguidice, D.P.C.**



Date	NOVEMBER 2024
Scale	AS SHOWN
Sheet Number	C001
Project Number	2271.010.001

**REVIEW ONLY NOT FOR CONSTRUCTION**

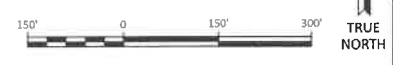

Plotted: Nov 26, 2024 - 4:18PM  
 I:\Projects\2201\2271.010.001 Site Layout Sheets.dwg  
 Drawn by: R.A.M.  
 Checked by: KJK  
 Designed by: KJK  
 In charge of: CAW

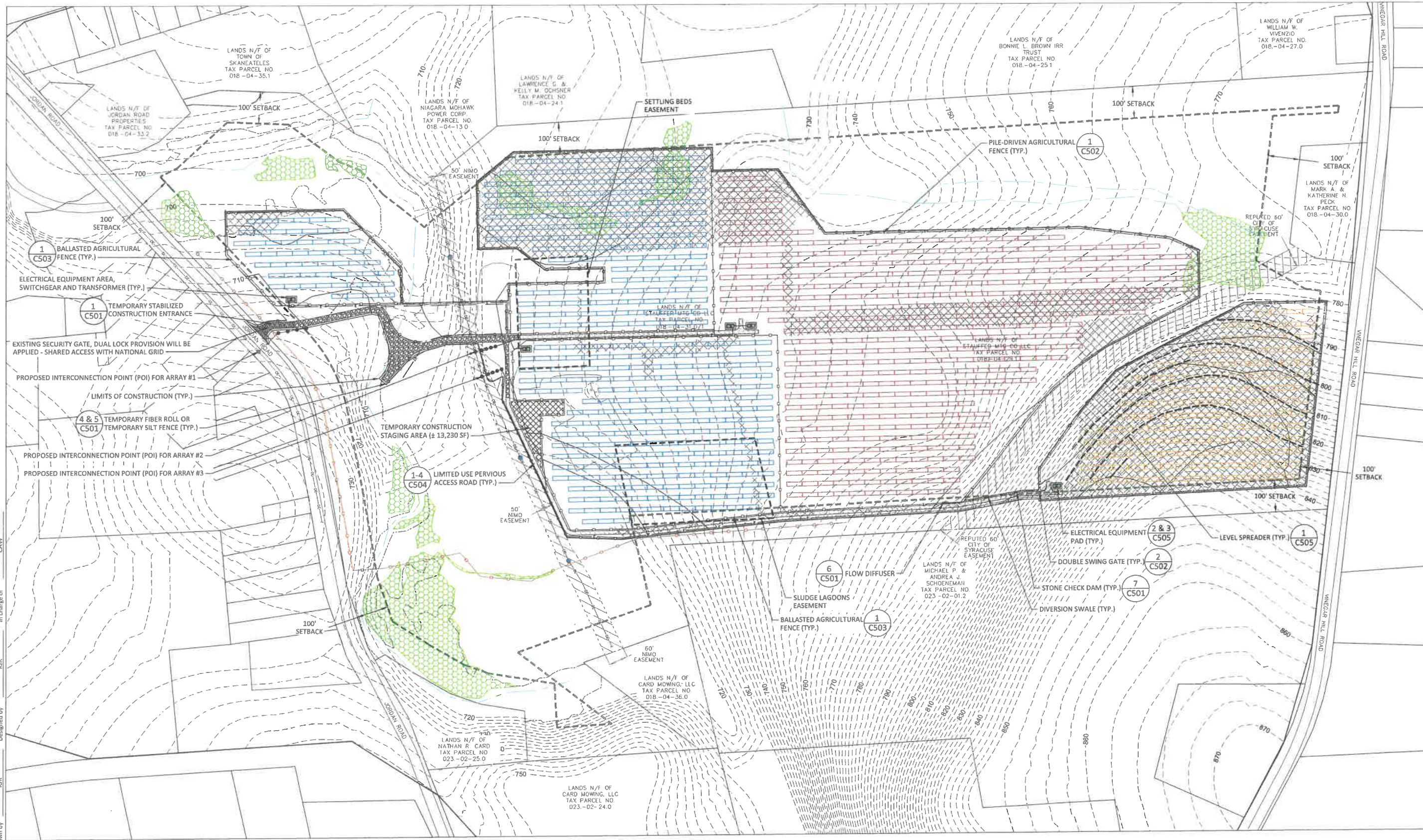

**SOLAR ARRAY LEGEND**

- SOLAR PANELS IN ARRAY #1
- SOLAR PANELS IN ARRAY #2
- SOLAR PANELS IN ARRAY #3

**SOLAR ARRAY NOTES:**

- ARRAY #1: POI ON THE EXISTING FEEDER 13.2KV AT JORDAN ROAD, 12,350 BIFACIAL MODULES@580WP; BALLAST RACKING SYSTEM; TILT =30°; AZIMUTH = 0°; 7,163 KW DC / 5,000 KW AC
- ARRAY #2: POI ON THE SUB-T LINE: JEW.-SOLVAY 26; SKAN. FALLS TAP 12,350 BIFACIAL MODULES@580WP; BALLAST RACKING SYSTEM; TILT =30°; AZIMUTH = 0°; 7,163 KW DC / 5,000 KW AC
- ARRAY #3: POI ON THE SUB-T LINE: JEW.-SOLVAY 26; SKAN. FALLS TAP 3,952 BIFACIAL MODULES@580WP; BALLAST RACKING SYSTEM; TILT =30°; AZIMUTH = 0°; 2,292.16 KW DC / 1,600 KW AC

**NOTES:**

1. ALL SOLAR PANELS AND AGRICULTURAL FENCING WITHIN TAX PARCEL 018.-04-31.0/1 ARE TO BE BALLASTED. REFER TO DETAILS ON SHEET C503 AND DETAILS 5 & 6 ON SHEET C505.
2. ALL SOLAR PANELS AND AGRICULTURAL FENCING WITHIN TAX PARCEL 018.-04-29.1 ARE TO BE PILE-DRIVEN. REFER TO DETAILS ON C502 AND DETAIL 4 ON SHEET C505.

IT IS A VIOLATION OF THE NEW YORK STATE EDUCATION LAW, ARTICLE 145 §7205 SPECIAL PROVISIONS, FOR ANY PERSON, UNLESS THEY ARE ACTING UNDER THE DIRECTION OF A LICENSED PROFESSIONAL ENGINEER, ARCHITECT, LANDSCAPE ARCHITECT, OR LAND SURVEYOR, TO ALTER AN ITEM IN ANY WAY, IF AN ITEM BEARING THE STAMP OF A LICENSED PROFESSIONAL IS ALTERED, THE ALTERING PROFESSIONAL SHALL STAMP THE DOCUMENT AND INCLUDE THE NOTATION "ALTERED BY" FOLLOWED BY THEIR SIGNATURE, THE DATE OF SUCH ALTERATION, AND A SPECIFIC DESCRIPTION OF THE ALTERATION.

REVISIONS

SUNN LLC  
 JORDAN ROAD SOLAR ENERGY SYSTEM

**PRELIMINARY CIVIL SITE PLAN**

TOWN OF SKANEATELES  
 ONONDAGA COUNTY, NEW YORK

**B&L**  
 443 Electronics Parkway  
 Liverpool, NY  
 13088  
**Barton & Loguidice, D.P.C.**



Date: NOVEMBER 2024  
 Scale: AS SHOWN  
 Sheet Number: C101  
 Project Number: 2271.010.001

**REVIEW ONLY NOT FOR CONSTRUCTION**



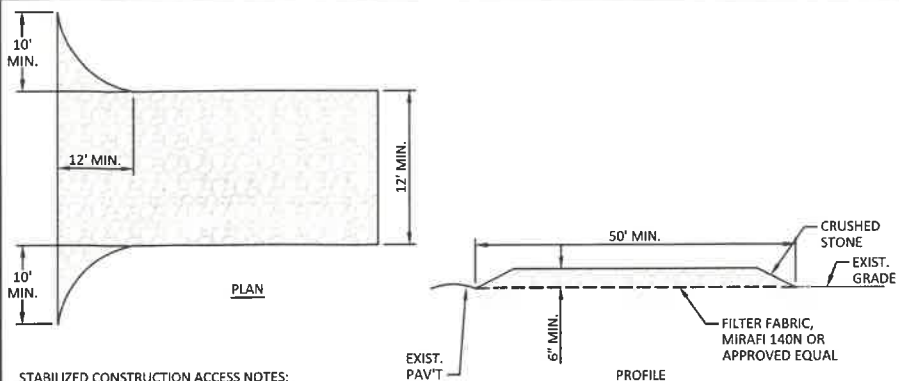

- STABILIZED CONSTRUCTION ACCESS NOTES:**
1. MODIFICATIONS MAY BE REQUIRED TO MEET FIELD CONDITIONS.
  2. ALL WORK TO CONSTRUCT THE STABILIZED ENTRANCE, INCLUDING GRADING, EXCAVATION, FILL, GEOTEXTILE, CRUSHED STONE, GRAVEL, CORRUGATED STEEL PANELS, ETC., SHALL BE INCLUDED IN THE LUMP SUM BID ITEM.
  3. GEOTEXTILE SHALL BE PLACED OVER THE ENTIRE AREA OF STABILIZED CONSTRUCTION ENTRANCE PRIOR TO PLACING STONE. STONE SHALL MEET THE REQUIREMENTS OF NYS DOT ITEM 623.12, CRUSHED NO. 3 STONE.
  4. ALL SURFACE WATER SHALL BE DIVERTED AWAY FROM CONSTRUCTION ENTRANCE. A MOUNTABLE BERM WITH 5:1 SLOPE IS PERMITTED.
  5. THE ENTRANCE SHALL BE MAINTAINED IN A CONDITION WHICH WILL PREVENT TRACKING OR FLOWING OF SEDIMENT ONTO PUBLIC RIGHT OF WAY. ALL SEDIMENT SPILLED, DROPPED, WASHED OR TRACKED ONTO PUBLIC RIGHT OF WAY MUST BE REMOVED IMMEDIATELY.
  6. WHEN WASHING IS REQUIRED, IT SHALL BE DONE ON AN AREA WITH STONE AND WHICH DRAINS ONTO AN APPROVED SEDIMENT TRAPPING DEVICE (OR CORRUGATED STEEL PANELS).
  7. PERIODIC INSPECTION AND NEEDED MAINTENANCE SHALL BE DONE REGULARLY AND FOLLOWING EACH RAINFALL.

**1** TEMPORARY STABILIZED CONSTRUCTION ENTRANCE  
C501 NOT TO SCALE

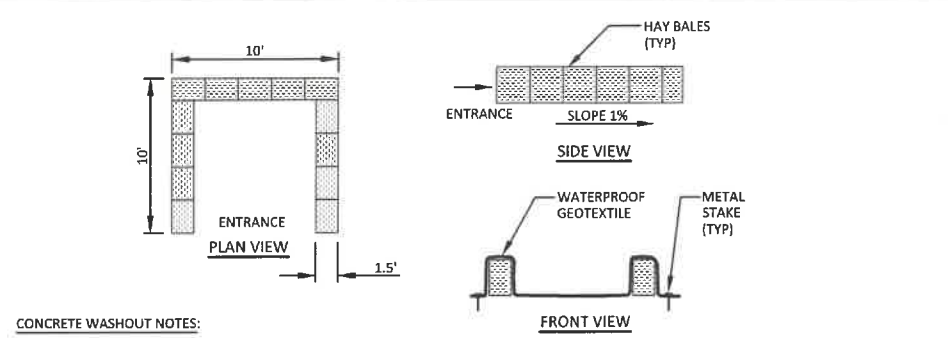

- CONCRETE WASHOUT NOTES:**
1. GEOTEXTILE SHALL BE INSPECTED DAILY TO ENSURE THAT IT REMAINS WATERPROOF.
  2. GEOTEXTILE SHALL BE SECURED TO GROUND WITH METAL STAKES OUTSIDE OF HAY BALE.
  3. CONCRETE WASHOUT AREA(S) SHALL BE INSTALLED PRIOR TO CONCRETE PLACEMENT ON SITE. THE CONCRETE WASHOUT AREA SHALL BE ENTIRELY SELF-CONTAINED.
- SIZE: THE WASHOUT MUST HAVE SUFFICIENT VOLUME TO CONTAIN ALL LIQUID AND CONCRETE WASTE GENERATED BY WASHOUT OPERATIONS INCLUDING, BUT NOT LIMITED TO, OPERATIONS ASSOCIATED WITH GROUT AND MORTAR.
4. SIGNS SHOULD BE PLACED AT THE CONSTRUCTION ENTRANCE, AT THE CONCRETE AREA(S) AND ELSEWHERE AS NECESSARY TO CLEARLY INDICATE THE LOCATION OF THE CONCRETE WASHOUT TO OPERATORS OF THE CONCRETE TRUCKS AND PUMP RIGS. WASHOUT AREA(S) SHOULD BE FLAGGED WITH SAFETY FENCING OR OTHER APPROVED METHOD.
  5. WASHOUT AREA(S) ARE TO BE INSPECTED AT LEAST ONCE A WEEK FOR STRUCTURAL INTEGRITY, ADEQUATE HOLDING CAPACITY AND CHECK FOR LEAKS, TEARS, OR OVERFLOWS. (AS REQUIRED BY THE CONSTRUCTION SITE ENVIRONMENTAL INSPECTION REPORT) WASHOUT AREA(S) SHOULD BE CHECKED AFTER HEAVY RAINS.
  6. HARDENED CONCRETE WASTE SHOULD BE REMOVED AND DISPOSED OF WHEN THE WASTE HAS ACCUMULATED TO HALF OF THE CONCRETE WASHOUT'S HEIGHT. THE WASTE CAN BE STORED AT AN UPLAND LOCATION, AS APPROVED BY THE ENGINEER. ALL CONCRETE WASTE SHALL BE DISPOSED OF IN A MANNER CONSISTENT WITH ALL APPLICABLE LAWS, REGULATIONS, AND GUIDELINES.

**2** CONCRETE WASHOUT AREA  
C-501 NOT TO SCALE

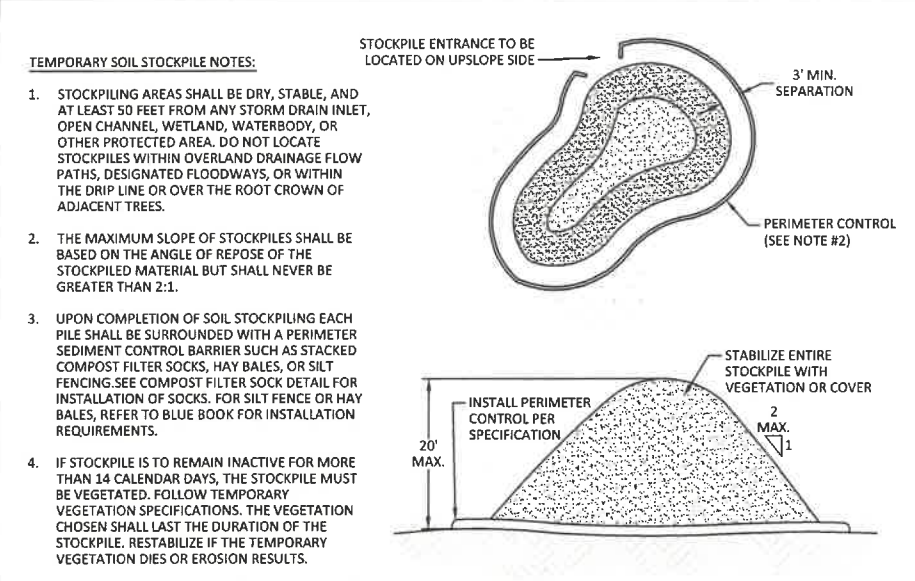

- TEMPORARY SOIL STOCKPILE NOTES:**
1. STOCKPILING AREAS SHALL BE DRY, STABLE, AND AT LEAST 50 FEET FROM ANY STORM DRAIN INLET, OPEN CHANNEL, WETLAND, WATERBODY, OR OTHER PROTECTED AREA. DO NOT LOCATE STOCKPILES WITHIN OVERLAND DRAINAGE FLOW PATHS, DESIGNATED FLOODWAYS, OR WITHIN THE DRIP LINE OR OVER THE ROOT CROWN OF ADJACENT TREES.
  2. THE MAXIMUM SLOPE OF STOCKPILES SHALL BE BASED ON THE ANGLE OF REPOSE OF THE STOCKPILED MATERIAL BUT SHALL NEVER BE GREATER THAN 2:1.
  3. UPON COMPLETION OF SOIL STOCKPILING EACH PILE SHALL BE SURROUNDED WITH A PERIMETER SEDIMENT CONTROL BARRIER SUCH AS STACKED COMPOST FILTER SOCKS, HAY BALES, OR SILT FENCING. SEE COMPOST FILTER SOCK DETAIL FOR INSTALLATION OF SOCKS. FOR SILT FENCE OR HAY BALES, REFER TO BLUE BOOK FOR INSTALLATION REQUIREMENTS.
  4. IF STOCKPILE IS TO REMAIN INACTIVE FOR MORE THAN 14 CALENDAR DAYS, THE STOCKPILE MUST BE VEGETATED. FOLLOW TEMPORARY VEGETATION SPECIFICATIONS. THE VEGETATION CHOSEN SHALL LAST THE DURATION OF THE STOCKPILE. RESTABILIZE IF THE TEMPORARY VEGETATION DIES OR EROSION RESULTS.

**3** TEMPORARY SOIL STOCKPILING  
C501 NOT TO SCALE

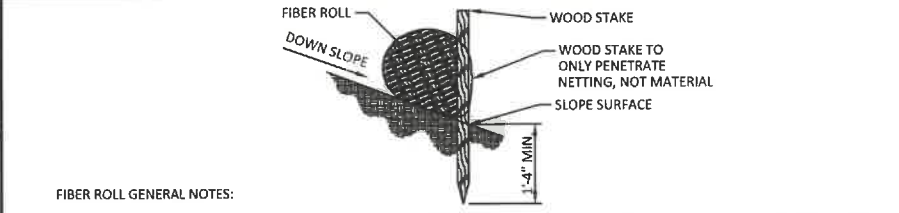

- FIBER ROLL GENERAL NOTES:**
1. FIBER ROLL DIKE SHALL BE PLACED A MINIMUM OF 2 FEET FROM TOE OF SLOPE, (5 FEET PREFERRED), TO PROVIDE ADEQUATE AREA FOR SEDIMENT STORAGE AND TO FACILITATE MAINTENANCE OF SEDIMENT CONTAINMENT AREA.
  2. POSTS MAY BE 1.5" X 1.5" (MINIMUM) HARDWOOD, 1.5" X 3.5" (MINIMUM) SOFTWOOD, OR 2kg/m (MIN) STEEL. SPACING SHALL BE 36" (MAXIMUM) BETWEEN STAKES.
  3. FIBER ROLLS SHALL BE INSTALLED PARALLEL TO THE CONTOUR. FIBER ROLLS ARE NOT TO BE INSTALLED SO THAT RUNOFF WILL FLOW ALONG THE FIBER ROLL IN A CONCENTRATED MANNER.
  4. FIBER ROLLS SHALL NOT BE USED IN OR ACROSS A FLOWING NATURAL CHANNEL.
  5. SEDIMENT SHALL BE REMOVED WHEN ACCUMULATION REACHES ONE-HALF OF THE MEASURE HEIGHT. SEDIMENT SHALL BE DISPOSED OF AS UNSUITABLE MATERIAL.
  6. AS PART OF FINAL STABILIZATION, WOODEN STAKES TO BE REMOVED AND FIBER LOG NETTING CUT OPEN ALONG ENTIRE LENGTH.

**4** TEMPORARY FIBER ROLL  
C501 NOT TO SCALE

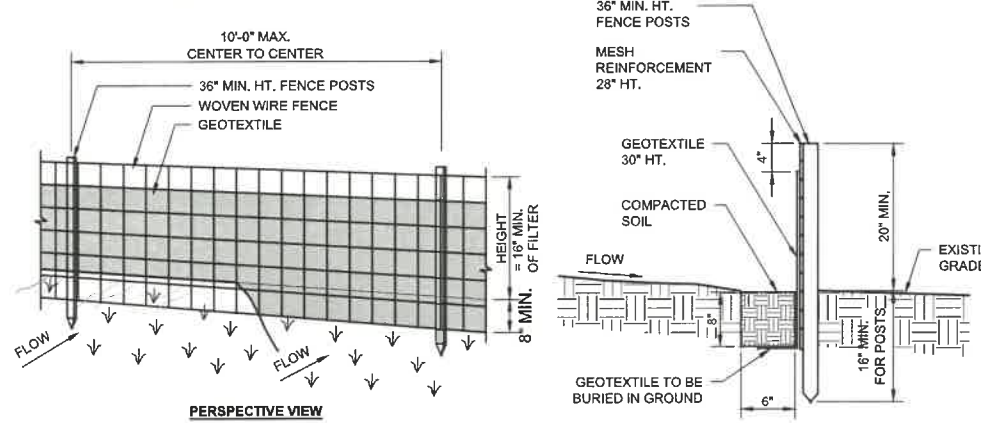

- CONSTRUCTION NOTES FOR FABRICATED SILT FENCE:**
1. WOVEN WIRE FENCE TO BE FASTENED SECURELY TO FENCE POSTS WITH WIRE TIES OR STAPLES.
  2. FILTER CLOTH TO BE FASTENED SECURELY TO WOVEN WIRE FENCE WITH TIES SPACED EVERY 24" AT TOP AND MID SECTION.
  3. WHEN TWO SECTIONS OF FILTER CLOTH ADJOIN EACH OTHER THEY SHALL BE OVERLAPPED BY SIX INCHES AND FOLDED.
  4. MAINTENANCE SHALL BE PERFORMED AS NEEDED AND MATERIAL/DEBRIS REMOVED WHEN 'BULGES' DEVELOP IN THE SILT FENCE.
  5. POSTS: STEEL EITHER "I" OR "U" TYPE OR 2" HARDWOOD. DRIVEN MIN. 16" INTO GROUND.
  6. FENCE: WOVEN WIRE 14 1/2 GA. 6" MAX. MESH OPENING.
  7. SILT FENCE FILTER FABRIC: FILTER X, MIRAFI 100X, STABILINKA T140N OR APPROVED EQUAL.
  8. PREFABRICATED UNIT: GEOFAB, ENVIROFENCE, OR APPROVED EQUAL.

**5** TEMPORARY SILT FENCE  
C501 NOT TO SCALE

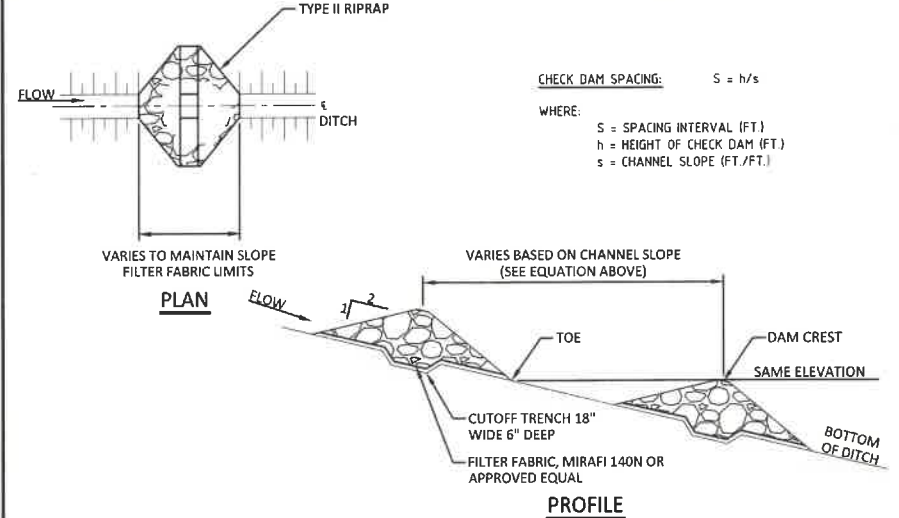

**7** STONE CHECK DAMS  
C501 NOT TO SCALE

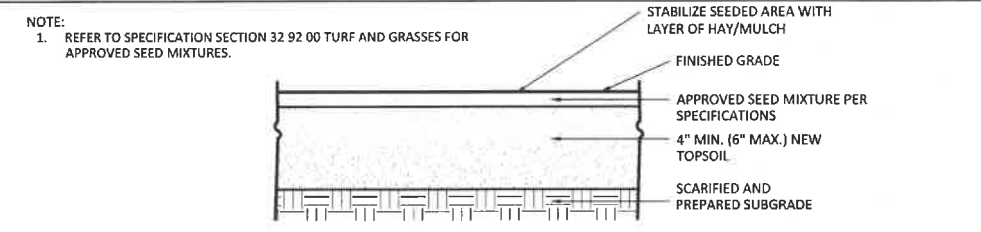

**8** SEED MIX ESTABLISHMENT  
C501 NOT TO SCALE

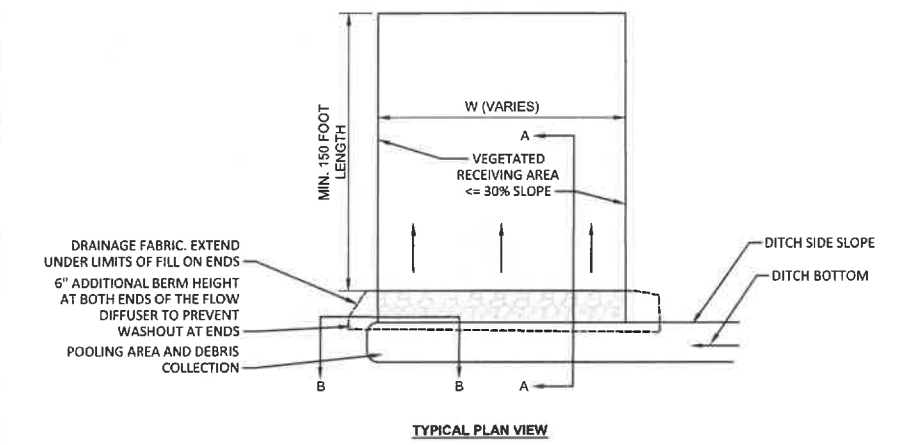

$W = Q_{10} / Q_d$

WHERE:  $Q_d$  = OUTFLOW THROUGH THE STONE DIFFUSER (CFS/FT)  
 $Q_{10}$  = DISCHARGE RATE FOR THE 10 YEAR STORM (CFS)  
 $W$  = LINEAR LENGTH OF THE DIFFUSER ALONG CENTERLINE (FT)

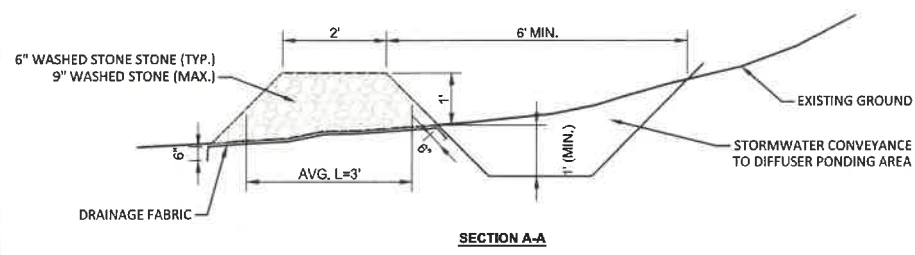
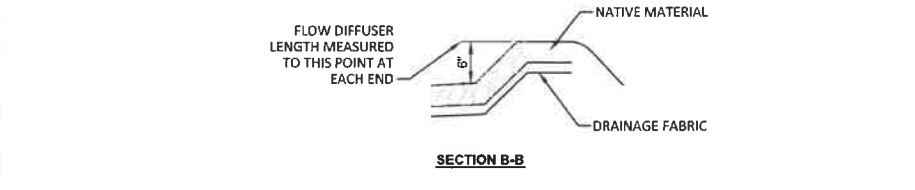

**6** FLOW DIFFUSER  
C501 NOT TO SCALE

REVIEW ONLY NOT FOR CONSTRUCTION

Plotted: Nov 26, 2024 - 4:19PM  
 By: mktts  
 Project: V2200\2271.010.001\2271.010.001\_C500\_Site\_Details.dwg  
 Drawn by: KJK  
 Checked by: RALM  
 In charge of: CAW

IT IS A VIOLATION OF THE NEW YORK STATE EDUCATION LAW, ARTICLE 145 §7209 SPECIAL PROVISIONS, FOR ANY PERSON, UNLESS THEY ARE ACTING UNDER THE DIRECTION OF A LICENSED PROFESSIONAL ENGINEER, ARCHITECT, LANDSCAPE ARCHITECT, OR LAND SURVEYOR, TO ALTER AN ITEM IN ANY WAY, IF AN ITEM BEARING THE STAMP OF A LICENSED PROFESSIONAL IS ALTERED. THE ALTERING PROFESSIONAL SHALL STAMP THE DOCUMENT AND INCLUDE THE NOTATION "ALTERED BY" FOLLOWED BY THEIR SIGNATURE, THE DATE OF SUCH ALTERATION, AND A SPECIFIC DESCRIPTION OF THE ALTERATION.

REVISIONS

JORDAN ROAD SOLAR ENERGY SYSTEM

SUNN LLC

443 Electronics Parkway  
Liverpool, NY 13088

Barton & Loguidice, D.P.C.

STATE OF NEW YORK  
CHARLES A. WHITE  
LICENSED PROFESSIONAL ENGINEER  
No. 081958

Date: NOVEMBER 2024  
 Scale: AS SHOWN  
 Sheet Number: C501  
 Project Number: 2271.010.001

ONONDAGA COUNTY, NEW YORK

TOWN OF SKANEATELES

**SITE DETAILS 1**

IT IS A VIOLATION OF THE NEW YORK STATE EDUCATION LAW, ARTICLE 145 §7209 SPECIAL PROVISIONS, FOR ANY PERSON, UNLESS THEY ARE ACTING UNDER THE DIRECTION OF A LICENSED PROFESSIONAL ENGINEER, ARCHITECT, LANDSCAPE ARCHITECT, OR LAND SURVEYOR, TO ALTER AN ITEM IN ANY WAY. IF AN ITEM BEARING THE STAMP OF A LICENSED PROFESSIONAL IS ALTERED, THE ALTERING PROFESSIONAL SHALL STAMP THE DOCUMENT AND INCLUDE THE NOTATION "ALTERED BY" FOLLOWED BY THEIR SIGNATURE, THE DATE OF SUCH ALTERATION, AND A SPECIFIC DESCRIPTION OF THE ALTERATION.

NO.	REVISIONS

SUNN LLC  
JORDAN ROAD SOLAR ENERGY SYSTEM

ONONDAGA COUNTY, NEW YORK  
TOWN OF SKANEATELES

44-3 Electronics Parkway  
Liverpool, NY 13088

**B&L**  
Barton & Loguidice, D.P.C.



Date: NOVEMBER 2024  
Scale: AS SHOWN  
Sheet Number: C502  
Project Number: 2271.010.001

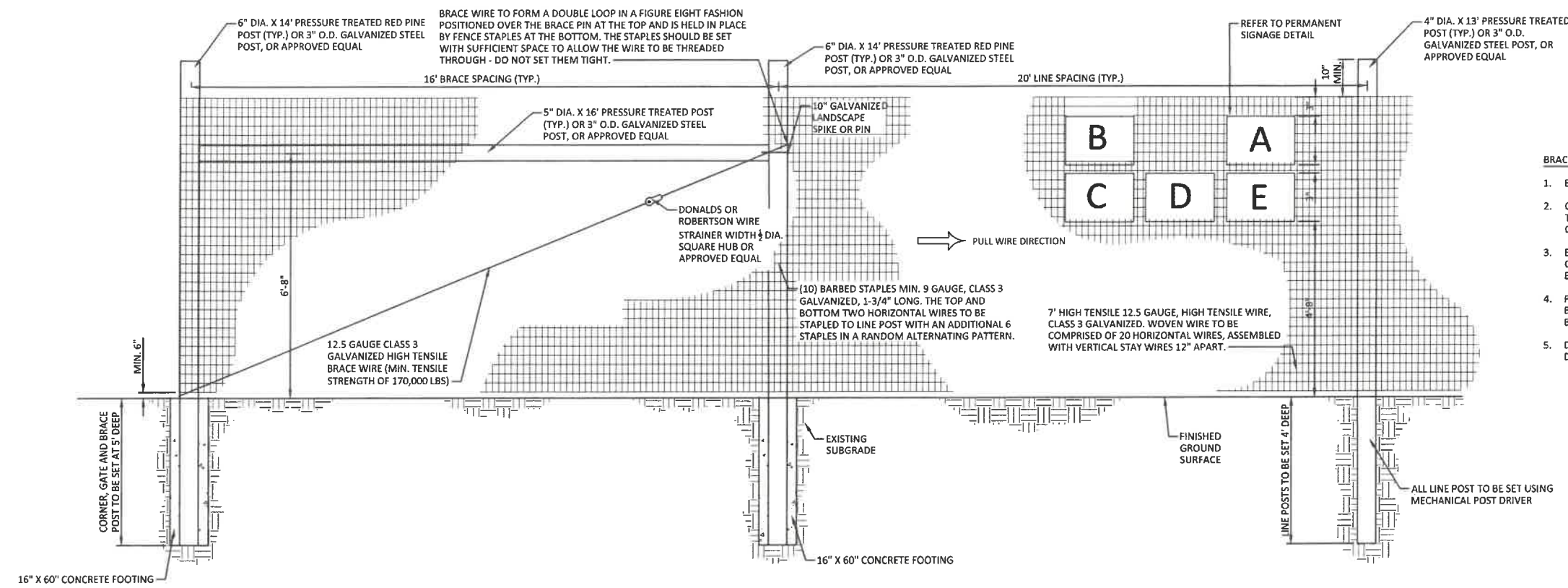

**BRACING NOTES:**

- BRACING IS REQUIRED AT ALL CORNER, END, GATE, AND PULL ASSEMBLIES IN THE FENCE.
- CORNERS ARE REQUIRED AT ALL POINTS WHERE THE FENCE ALIGNMENT CHANGES 15 DEGREES OR MORE. THREE 6" X 16" VERTICAL POSTS AND TWO 5" X 16" HORIZONTAL BRACES ARE REQUIRED FOR EACH CORNER.
- END BRACING IS REQUIRED WHERE THE FENCE ENDS AT A BUILDING OR ON EACH SIDE OF A GATE OPENING. TWO 6" X 16" VERTICAL POSTS AND ONE 5" X 16" HORIZONTAL BRACE ARE REQUIRED FOR EACH END BRACE.
- PULL ASSEMBLIES ARE REQUIRED IN STRAIGHT SECTIONS OF FENCE SO THAT THE MAXIMUM DISTANCE BETWEEN CORNERS DOES NOT EXCEED 1,320 FEET. TWO 6" X 16" VERTICAL POSTS AND ONE 5" X 16" BRACE ARE REQUIRED.
- DOUBLE BRACES SHOULD BE USED ON EACH END FOR STRAIGHT FENCE LINES EXCEEDING 1,000 FEET. DOUBLE END BRACES REQUIRE THREE 6" X 16" POSTS AND TWO 5" X 16" HORIZONTAL BRACES.

1 PILE-DRIVEN AGRICULTURAL FENCE  
C502 NOT TO SCALE

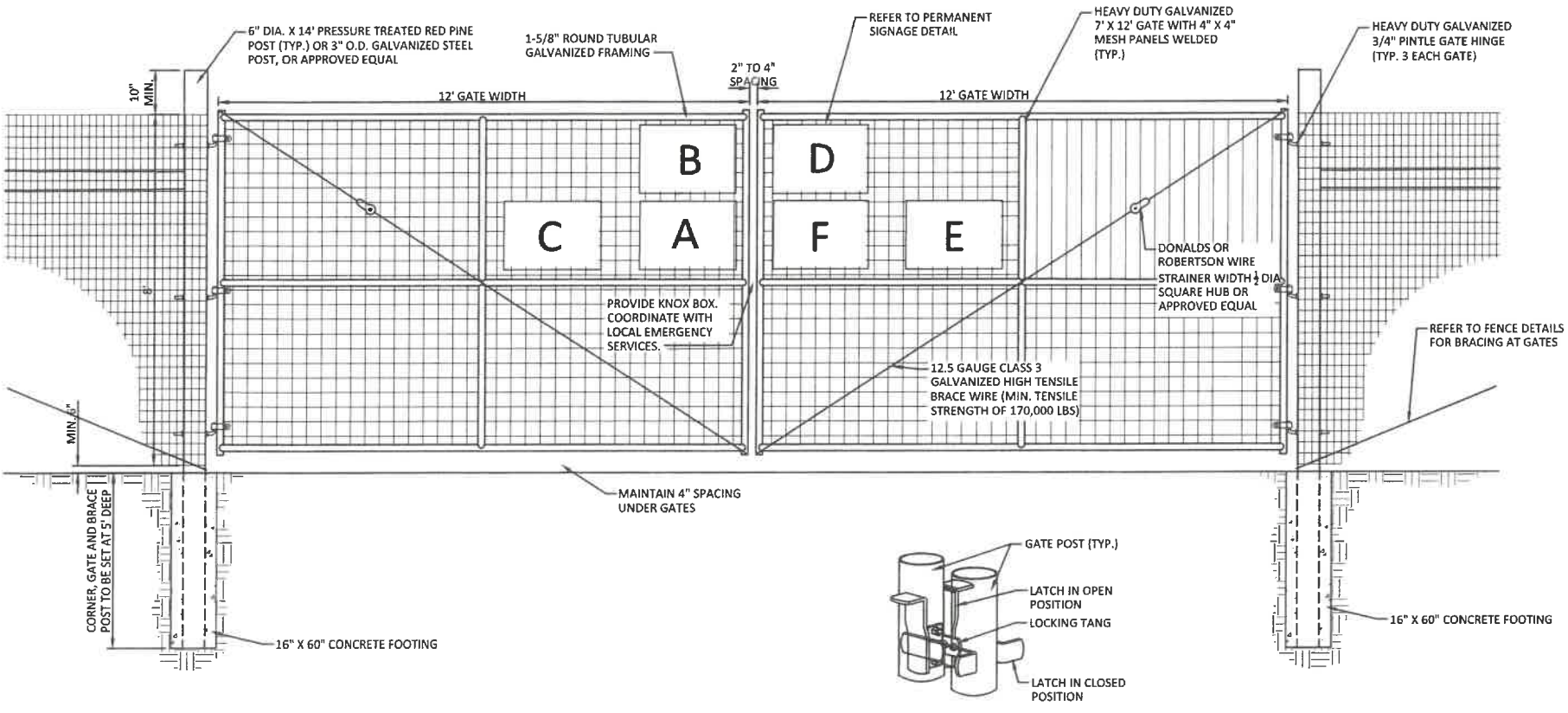

2 7' TALL 24' WIDE PILE-DRIVEN DOUBLE SWING GATE  
C502 NOT TO SCALE

A -		- B
C -		- D
E -		- F

**NOTES:**

- ALL SIGNS TO BE 18" X 24" IN SIZE.
- SIGNS SHALL BE UV RESISTANT AND IN COLOR. SIGN MATERIAL SHALL BE HDPE OR LIGHT GAUGE GALVANIZED STEEL.
- SIGNS TO BE ATTACHED TO FENCING WITH PERMANENT FASTENERS.
- SIGNS SHALL BE INSTALLED IN GROUPS EVERY 300'.
- FINAL SIGN GRAPHICS SHALL BE REVIEWED AND APPROVED BY THE OWNER.

3 PERMANENT SIGNAGE  
C502 NOT TO SCALE

**REVIEW ONLY NOT FOR CONSTRUCTION**

Plotted: Nov 26, 2024 - 4:19PM  
l:\Projects\2200\2271.010.001 C500 Site Details.dwg  
Checked by: RAM  
Designed by: KJK  
In charge of: CAW

IT IS A VIOLATION OF THE NEW YORK STATE EDUCATION LAW, ARTICLE 145 §209 SPECIAL PROVISIONS, FOR ANY PERSON, UNLESS THEY ARE ACTING UNDER THE DIRECTION OF A LICENSED PROFESSIONAL ENGINEER, ARCHITECT, LANDSCAPE ARCHITECT, OR LAND SURVEYOR, TO ALTER AN ITEM IN ANY WAY. IF AN ITEM BEARING THE STAMP OF A LICENSED PROFESSIONAL IS ALTERED, THE ALTERING PROFESSIONAL SHALL STAMP THE DOCUMENT AND INCLUDE THE NOTATION "ALTERED BY" FOLLOWED BY THEIR SIGNATURE, THE DATE OF SUCH ALTERATION, AND A SPECIFIC DESCRIPTION OF THE ALTERATION.

REVISIONS

SUNN LLC  
 JORDAN ROAD SOLAR ENERGY SYSTEM  
 ONONDAGA COUNTY, NEW YORK

**SITE DETAILS 3**

TOWN OF SKANEATELES

443 Electronics Parkway  
 Liverpool, NY 13088  
**B&L**  
**Barton & Loguidice, D.P.C.**



Date	NOVEMBER 2024
Scale	AS SHOWN
Sheet Number	<b>C503</b>
Project Number	2271.010.001

**BRACING NOTES:**

- BRACING IS REQUIRED AT ALL CORNER, END, GATE, AND PULL ASSEMBLIES IN THE FENCE.
- CORNERS ARE REQUIRED AT ALL POINTS WHERE THE FENCE ALIGNMENT CHANGES 15 DEGREES OR MORE. THREE 6" X 16" VERTICAL POSTS AND TWO 5" X 16" HORIZONTAL BRACES ARE REQUIRED FOR EACH CORNER.
- END BRACING IS REQUIRED WHERE THE FENCE ENDS AT A BUILDING OR ON EACH SIDE OF A GATE OPENING. TWO 6" X 16" VERTICAL POSTS AND ONE 5" X 16" HORIZONTAL BRACE ARE REQUIRED FOR EACH END BRACE.
- PULL ASSEMBLIES ARE REQUIRED IN STRAIGHT SECTIONS OF FENCE SO THAT THE MAXIMUM DISTANCE BETWEEN CORNERS DOES NOT EXCEED 1,320 FEET. TWO 6" X 16" VERTICAL POSTS AND ONE 5" X 16" BRACE ARE REQUIRED.
- DOUBLE BRACES SHOULD BE USED ON EACH END FOR STRAIGHT FENCE LINES EXCEEDING 1,000 FEET. DOUBLE END BRACES REQUIRE THREE 6" X 16" POSTS AND TWO 5" X 16" HORIZONTAL BRACES.

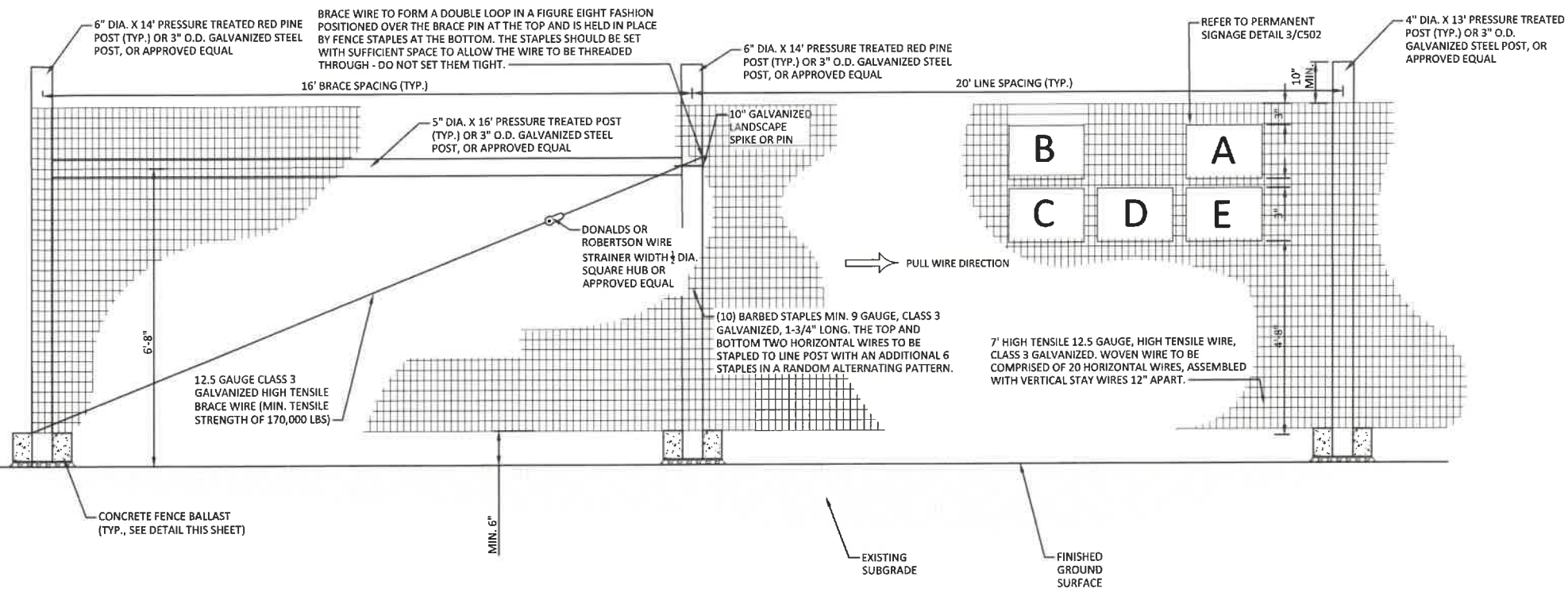

**1 BALLASTED 7' AGRICULTURAL FENCE**  
 C503 NOT TO SCALE

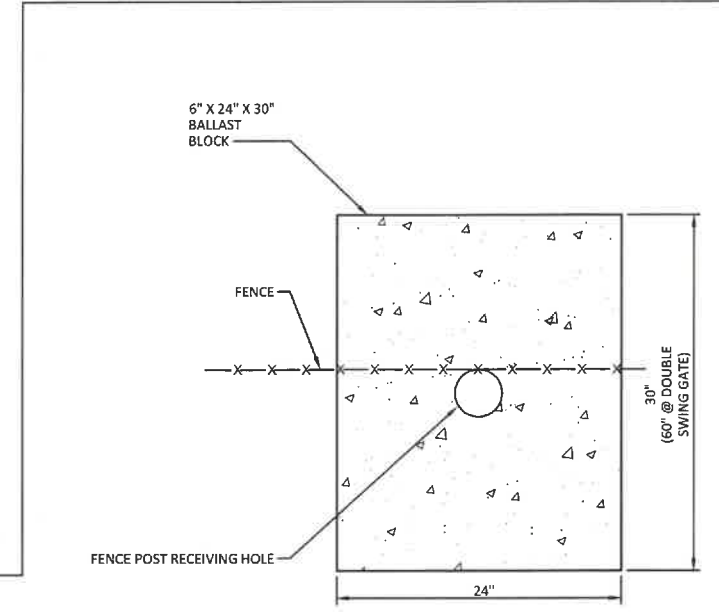

**TOP VIEW**

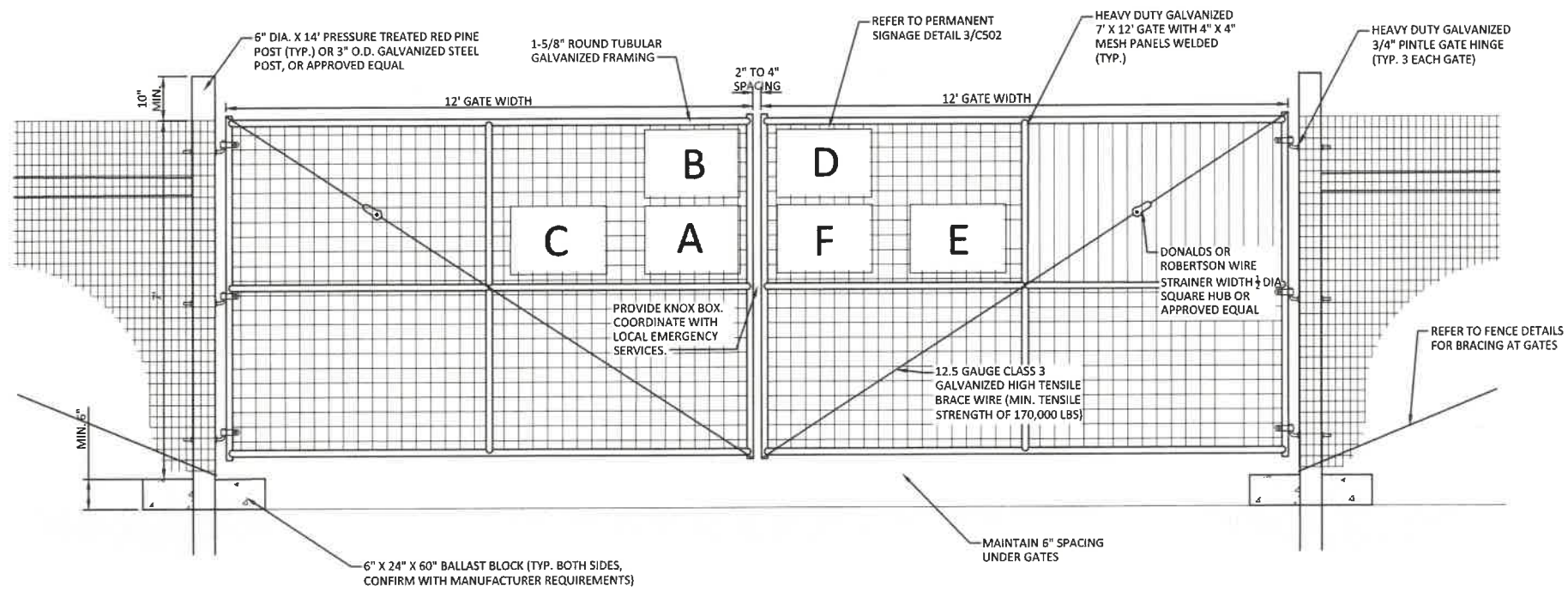

**2 7' TALL 24' WIDE BALLASTED DOUBLE SWING GATE**  
 C503 NOT TO SCALE

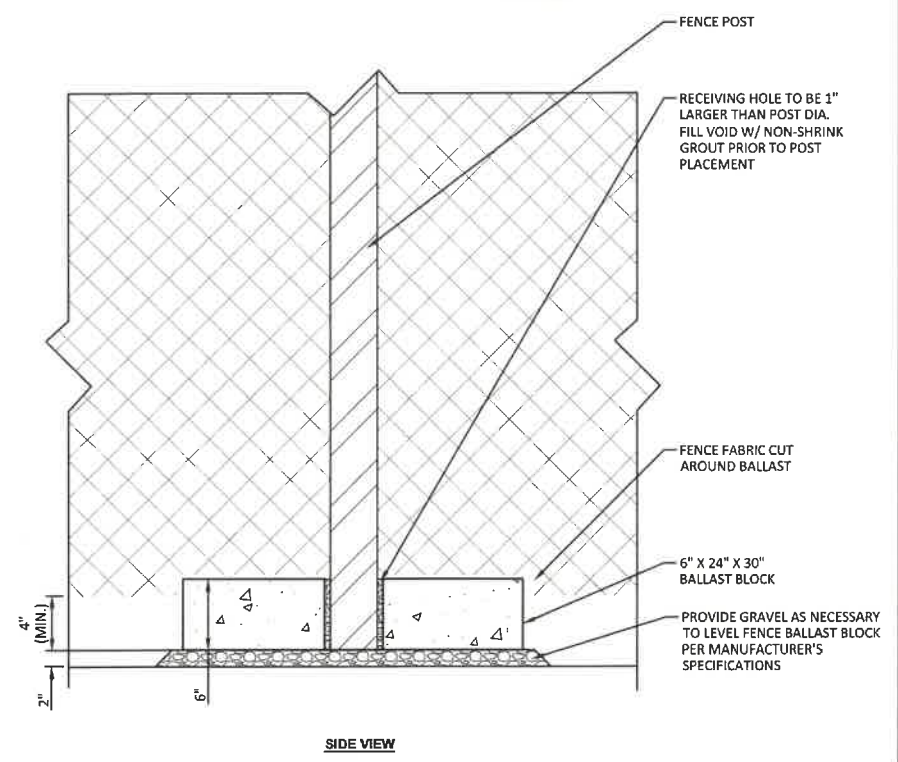

**SIDE VIEW**

**3 CONCRETE FENCE BALLAST DETAIL**  
 C503 NOT TO SCALE

**REVIEW ONLY NOT FOR CONSTRUCTION**

Plotted: Nov 26, 2024 - 4:19PM By: mklts  
 I:\Projects\2271.010.001\C503 Site Details.dwg  
 Checked by: RAKM  
 Drawn by: KJK  
 Designed by: KJK  
 In charge of: CAW

**GENERAL NOTES:**

- USE OF THIS DETAIL/CRITERION IS LIMITED TO ACCESS ROADS USED ON AN OCCASIONAL BASIS ONLY (I.E., PROVIDE ACCESS FOR MOWING, EQUIPMENT REPAIR OR MAINTENANCE, ETC.).
- LIMITED USE PERVIOUS ACCESS ROAD IS LIMITED TO LOW IMPACT IRREGULAR MAINTENANCE ACCESS ASSOCIATED WITH RENEWABLE ENERGY PROJECTS IN NEW YORK STATE.
- REMOVE STUMPS, ROCKS AND DEBRIS AS NECESSARY. FILL VOIDS TO MATCH EXISTING NATIVE SOILS AND COMPACTION LEVEL.
- REMOVED TOPSOIL MAY BE SPREAD IN ADJACENT AREAS AS DIRECTED BY THE PROJECT ENGINEER. COMPACT TO THE DEGREE OF THE NATIVE INSITU SOIL. DO NOT PLACE IN AN AREA THAT IMPEDES STORMWATER DRAINAGE.
- GRADE ROADWAY, WHERE NECESSARY, TO NATIVE SOIL AND DESIRED ELEVATION. MINOR GRADING FOR CROSS SLOPE CUT AND FILL MAY BE REQUIRED.
- REMOVE REFUSE SOILS AS DIRECTED BY THE PROJECT ENGINEER. DO NOT PLACE IN AN AREA THAT IMPEDES STORMWATER DRAINAGE.
- ROADWAY WIDTH PER THE SITE PLANS (SEE SHEETS C101 AND C102).
- THE LIMITED USE PERVIOUS ACCESS ROAD CROSS SLOPE SHALL BE 2% IN MOST CASES AND SHALL NOT EXCEED 6%. THE LONGITUDINAL SLOPE OF THE ACCESS DRIVE SHOULD NOT EXCEED 15%.
- LIMITED US PERVIOUS ACCESS ROAD IS NOT INTENDED TO BE UTILIZED FOR CONSTRUCTION WHICH MAY SUBJECT THE ACCESS TO SEDIMENT TRACKING. THIS SPECIFICATION IS TO BE DEVELOPED FOR POST-CONSTRUCTION USE. SOIL RESTORATION PRACTICES MAY BE APPLICABLE TO RESTORE CONSTRUCTION RELATED COMPACTION TO PRE-EXISTING CONDITIONS AND SHOULD BE VERIFIED BY SOIL PENETROMETER READINGS. THE PENETROMETER READINGS SHALL BE COMPARED TO THE RESPECTIVE RECORDED READINGS TAKEN PRIOR TO CONSTRUCTION, EVERY 100 LINEAR FEET ALONG THE PROPOSED ROADWAY.
- TO ENSURE THAT SOIL IS NOT TRACKED ONTO THE LIMITED USE PERVIOUS ACCESS ROAD, IT SHALL NOT BE USED BY CONSTRUCTION VEHICLES TRANSPORTING SOIL, FILL MATERIAL, ETC. IF THE LIMITED US PERVIOUS ACCESS IS COMPLETED DURING THE INITIAL PHASES OF CONSTRUCTION, A STANDARD NEW YORK STATE STABILIZED CONSTRUCTION ACCESS SHALL BE CONSTRUCTED AND UTILIZED TO REMOVE SEDIMENT FROM CONSTRUCTION VEHICLES AND EQUIPMENT PRIOR TO ENTERING THE LIMITED USE PERVIOUS ACCESS ROAD FROM ANY LOCATION ON, OR OFF SITE. MAINTENANCE OF THE PERVIOUS ACCESS ROAD WILL BE REQUIRED IF SEDIMENT IS OBSERVED WITHIN THE CLEAN STONE.
- THE LIMITED USE PERVIOUS ACCESS ROAD SHALL NOT BE CONSTRUCTED OR USED UNTIL ALL AREAS SUBJECT TO RUNOFF ONTO THE PERVIOUS ACCESS HAVE ACHIEVED FINAL STABILIZATION.
- PROJECT SHOULD AVOID INSTALLATION OF THE LIMITED USE PERVIOUS ACCESS ROAD IN POORLY DRAINED AREAS, HOWEVER IF NO ALTERNATIVE LOCATION IS AVAILABLE, THE PROJECT SHALL UTILIZE WOVEN GEOTEXTILE MATERIAL AS DETAILED IN THE FOLLOWING NOTES.
- THE DRAINAGE DITCH IS OFFERED IN THE DETAIL FOR CIRCUMSTANCES WHEN CONCENTRATED FLOW COULD NOT BE AVOIDED. THE INTENTION OF THIS DESIGN IS TO MINIMIZE ALTERATIONS TO HYDROLOGY, HOWEVER WHEN DEALING WITH 5%-15% GRADES NOT PARALLEL TO THE CONTOUR, A ROADSIDE DITCH MAY BE REQUIRED. THE NYS STANDARDS AND SPECIFICATIONS FOR EROSION AND SEDIMENT CONTROLS FOR GRASSED WATERWAYS AND VEGETATED WATERWAYS ARE APPLICABLE FOR SIZING AND STABILIZATION. DIMENSIONS FOR THE GRASSED WATERWAY SPECIFICATION WOULD BE DESIGNED FOR PROJECT SPECIFIC HYDROLOGIC RUNOFF CALCULATIONS, AND A SEPARATE DETAIL FOR THE SPECIFIC GRASSED WATERWAY WOULD BE INCLUDED IN THIS PRACTICE. RUNOFF DISCHARGES WILL BE SUBJECT TO THE OUTLET REQUIREMENTS OF THE REFERENCED STANDARDS. INCREASED POST-DEVELOPMENT RUNOFF FROM THE ASSOCIATED ROADSIDE DITCH MAY REQUIRE ADDITIONAL PRACTICES TO ATTENUATE RUNOFF TO PRE-DEVELOPMENT CONDITIONS.
- IF A ROADSIDE DITCH IS NOT UTILIZED TO CAPTURE RUNOFF FROM THE ACCESS ROAD, THE PERVIOUS ACCESS ROAD WILL HAVE A WELL-ESTABLISHED PERENNIAL VEGETATIVE COVER, WHICH SHALL CONSIST OF UNIFORM VEGETATION (I.E., BUFFER), 20 FEET WIDE AND PARALLEL TO THE DOWN GRADIENT SIDE OF THE ACCESS ROAD. POST-CONSTRUCTION OPERATION AND MAINTENANCE PRACTICES WILL MAINTAIN THE VEGETATIVE COVER TO ENSURE FINAL STABILIZATION FOR THE LIFE OF THE ACCESS ROAD.
- THE DESIGN PROFESSIONAL MUST ACCOUNT FOR THE LIMITED USE PERVIOUS ACCESS ROAD IN THEIR ASSESSMENT/HYDROLOGY ANALYSIS. IF THE HYDROLOGY ANALYSIS SHOWS THAT THE HYDROLOGY HAS BEEN ALTERED FROM PRE- TO POST-DEVELOPMENT CONDITIONS, THE DESIGN MUST INCLUDE THE NECESSARY DETENTION/RETENTION PRACTICES TO ATTENUATE THE RATES TO PRE-DEVELOPMENT CONDITIONS.

**GEOGRID MATERIAL NOTES:**

- THE GEOGRID, OR COMPARABLE PRODUCT, IS INTENDED FOR USE FOR ALL CONDITIONS, IN ORDER TO ASSIST IN MATERIAL SEPARATION FROM NATIVE SOILS AND PRESERVE ACCESS LOADS.
- CLEAN STONE MATERIAL SHALL CONSIST OF 1-4" CLEAN, DURABLE, SHARP-ANGLED CRUSHED STONE OF UNIFORM QUALITY, MEETING THE SPECIFICATIONS OF NYS DOT ITEM 703-02, SIZE DESIGNATION 3-5 OF TABLE 703-4. STONE MAY BE PLACED IN FRONT OF, AND SPREAD WITH, A TRACKED VEHICLE. CLEAN STONE SHALL NOT BE COMPACTED.
- GEOGRID SHALL BE MIRAFI BXG110 OR APPROVED EQUAL. GEOGRID SHALL BE DESIGNED BASED ON EXISTING SOIL CONDITIONS AND PROPOSED ROAD SLOPES.
- IF MORE THAN ONE ROLL WIDTH IS REQUIRED, ROLLS SHOULD OVERLAP A MINIMUM OF SIX INCHES.
- REFER TO MANUFACTURER'S SPECIFICATION FOR PROPER TYING AND CONNECTIONS.
- LIMITED US PERVIOUS ACCESS ROAD SHALL BE TOP DRESSED AS REQUIRED WITH ONLY 1-4" CRUSHED STONE MEETING NYS DOT ITEM 703-2 SPECIFICATIONS.

**GEOWEB MATERIAL NOTES:**

- THE GEOWEB, OR COMPARABLE PRODUCT, IS SUGGESTED FOR USE ON ROAD PROFILES EXCEEDING 10%. THE GEOWEB PRODUCT IS INTENDED TO LIMIT SHIFTING STONE MATERIAL DURING USE.
- INSTALLATION TO BE COMPLETED IN ACCORDANCE WITH MANUFACTURER'S SPECIFICATIONS.
- WHERE REQUIRED, A NATIVE SOIL WEDGE SHALL BE PLACED TO ACCOMMODATE ROAD CROSS SLOPE OF 2%. NATIVE SOIL SHALL BE COMPACTED TO MATCH EXISTING SOIL CONDITIONS.
- CLEAN STONE FILL MATERIAL SHALL CONSIST OF 1-4" CLEAN, DURABLE SHARP-ANGLED CRUSHED STONE OF UNIFORM QUALITY, MEETING THE SPECIFICATIONS OF NYS DOT ITEM 703-02, SIZE DESIGNATION 3-5 OF TABLE 703-4. STONE MAY BE PLACED IN FRONT OF, AND SPREAD WITH, A TRACKED VEHICLE. GRAVEL SHALL NOT BE COMPACTED.
- GEOWEB SYSTEM SHALL BE PRESTO GEOSYSTEM GEOWEB OR APPROVED EQUAL. GEOWEB SHALL BE DESIGNED BASED ON EXISTING SOIL CONDITIONS AND PROPOSED ROAD SLOPES.
- LIMITED USE PERVIOUS ACCESS ROAD SHALL BE TOP DRESSED AS REQUIRED WITH ONLY 1-4" CRUSHED STONE, SIZE 3A, MEETING NYS DOT ITEM 703-02 SPECIFICATIONS.
- THE TOP EDGES OF ADJACENT CELL WALLS SHALL BE FLUSH WHEN CONNECTING. ALIGN THE I-SLOTS FOR INTERLEAF AND END TO END CONNECTIONS. THE GEOWEB PANELS SHALL BE CONNECTED WITH ATRA KEYS AT EACH INTERLEAF AND END TO END CONNECTIONS. REFER TO MANUFACTURER'S SPECIFICATIONS FOR PROPER INSTALLATION, TYING AND CONNECTIONS.

**WOVEN GEOTEXTILE MATERIAL NOTES:**

- SPECIFIED GEOTEXTILE WILL ONLY BE UTILIZED IN PLACID SOILS. PLACID SOILS CONSIST OF POORLY DRAINED SOILS COMPOSED OF FINELY TEXTURED PARTICLES AND ARE PRONE TO RUTTING. PLACID SOILS ARE TYPICALLY PRESENT IN LOW-LYING AREAS WITH HYDROLOGIC SOILS GROUP (HSG) OD C OR D, OR AS SPECIFIED FROM AN ENVIRONMENTAL SCIENTIST, SOIL SCIENTIST, OR GEOTECHNICAL DATA.
- THE CONCERN FOR POTENTIAL REDUCTION OF NATIVE INFILTRATION RATES DUE TO THE GEOTEXTILE MATERIAL WOULD NOT BE A SIGNIFICANT CONCERN ON POORLY DRAINED SOILS WHERE SEGREGATION OF PERVIOUS STONE AND NATIVE MATERIALS IS CRUCIAL FOR LOG TERM OPERATION AND MAINTENANCE.

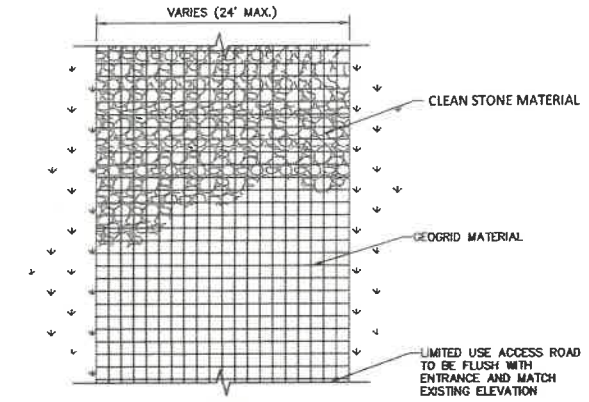

1 LIMITED USE PERVIOUS ACCESS ROAD - 0% TO 10% SLOPES  
C504 NOT TO SCALE

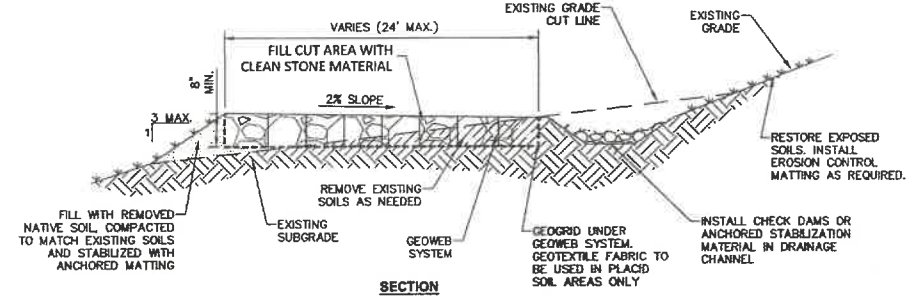

NOTE:  
1. THE ROADSIDE DITCH SHALL BE DESIGNED IN ACCORDANCE WITH THE NYS STANDARDS AND SPECIFICATIONS FOR EROSION AND SEDIMENT CONTROLS FOR GRASSED AND VEGETATED WATERWAYS. SEE GRADING PLAN (SHEET C102) FOR DETAILS.

2 LIMITED USE PERVIOUS ACCESS ROAD - 10% AND GREATER SLOPES WITH DITCH  
C504 NOT TO SCALE

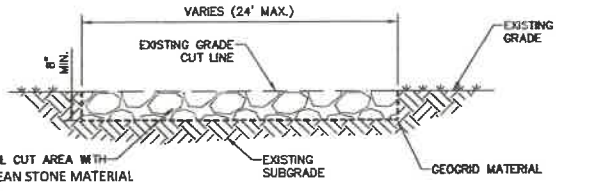

1 LIMITED USE PERVIOUS ACCESS ROAD - 0% TO 10% SLOPES  
C504 NOT TO SCALE

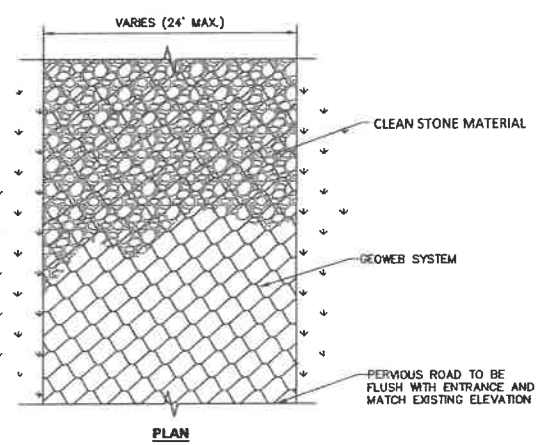

3 LIMITED USE PERVIOUS ACCESS ROAD - 10% AND GREATER SLOPES  
C504 NOT TO SCALE

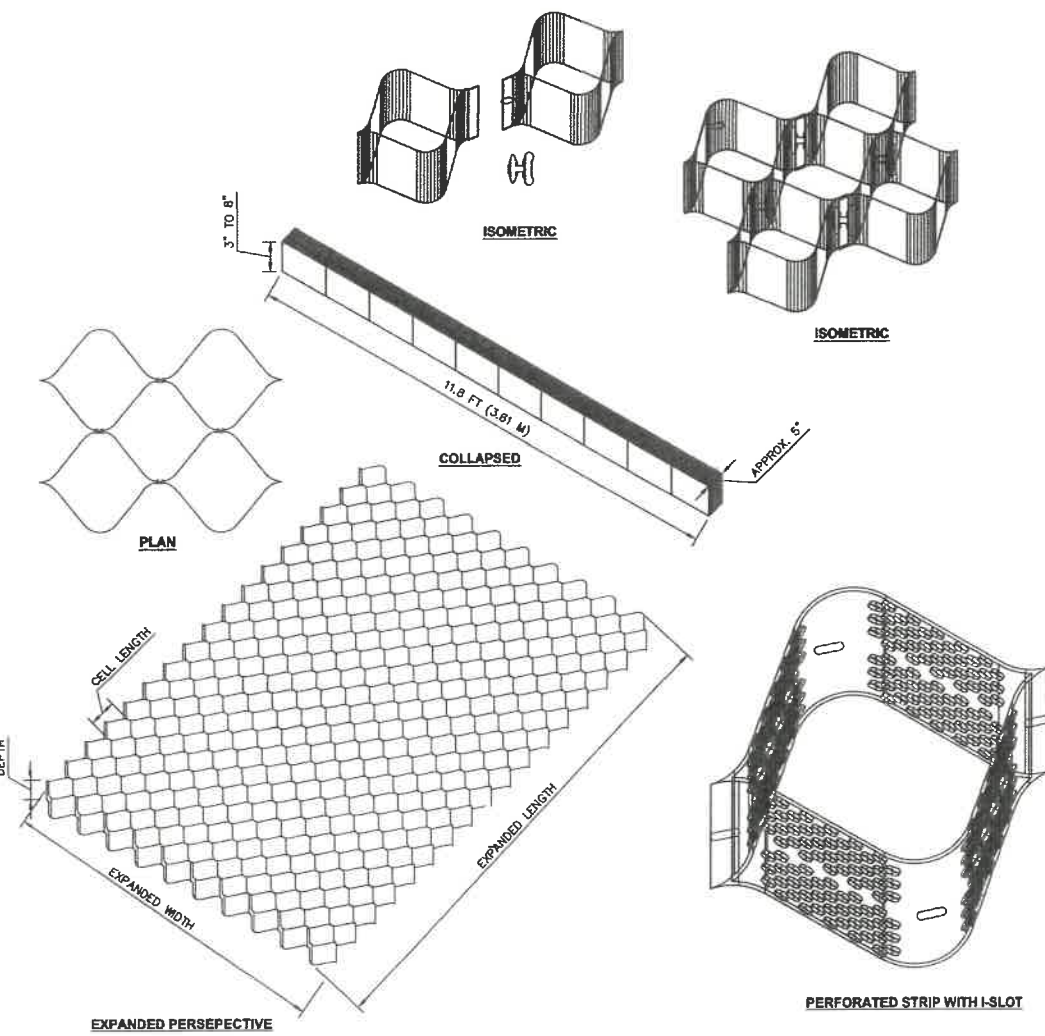

4 GEOWEB SYSTEM  
C504 NOT TO SCALE

Plotted: Nov 26, 2024 - 4:19PM  
 I:\Projects\2200\2271.010.001\C500 Site Details.dwg  
 Drawn by: KJK  
 Checked by: RAM  
 Designed by: KJK  
 In charge of: CAW

IT IS A VIOLATION OF THE NEW YORK STATE EDUCATION LAW, ARTICLE 145 §7209 SPECIAL PROVISIONS, FOR ANY PERSON, UNLESS THEY ARE ACTING UNDER THE DIRECTION OF A LICENSED PROFESSIONAL ENGINEER, ARCHITECT, LANDSCAPE ARCHITECT, OR LAND SURVEYOR, TO ALTER AN ITEM IN ANY WAY, IF AN ITEM BEARING THE STAMP OF A LICENSED PROFESSIONAL IS ALTERED, THE ALTERING PROFESSIONAL SHALL STAMP THE DOCUMENT AND INCLUDE THE NOTATION "ALTERED BY" FOLLOWED BY THEIR SIGNATURE, THE DATE OF SUCH ALTERATION, AND A SPECIFIC DESCRIPTION OF THE ALTERATION.

REVISIONS

SUNN LLC  
 JORDAN ROAD SOLAR ENERGY SYSTEM  
 ONONDAGA COUNTY, NEW YORK

TOWN OF SKANEATELES  
**SITE DETAILS 4**

443 Electronics Parkway  
 Liverpool, NY  
 13088  
**Barton & Loguidice, D.P.C.**



Date: NOVEMBER 2024  
 Scale: AS SHOWN  
 Sheet Number: C504  
 Project Number: 2271.010.001

**REVIEW ONLY NOT FOR CONSTRUCTION**



IF AS A VIOLATION OF THE NEW YORK STATE EDUCATION LAW, ARTICLE 145 § 2209 SPECIAL PROVISIONS, FOR ANY PERSON, UNLESS THEY ARE ACTING UNDER THE DIRECTION OF A LICENSED PROFESSIONAL ENGINEER, ARCHITECT, LANDSCAPE ARCHITECT, OR LAND SURVEYOR, TO ALTER AN ITEM IN ANY WAY, IF AN ITEM BEARING THE STAMP OF A LICENSED PROFESSIONAL IS ALTERED, THE ALTERING PROFESSIONAL SHALL STAMP THE DOCUMENT AND INCLUDE THE NOTATION "ALTERED BY" FOLLOWED BY THEIR SIGNATURE, THE DATE OF SUCH ALTERATION, AND A SPECIFIC DESCRIPTION OF THE ALTERATION.

NO.	REVISIONS

SUNN LLC  
 JORDAN ROAD SOLAR ENERGY SYSTEM  
 ONONDAGA COUNTY, NEW YORK

**SITE DETAILS 5**

TOWN OF SKANEATELES

443 Electronics Parkway  
 Liverpool, NY  
 13088  
**B&L**  
**Barton & Loguidice, D.P.C.**



Date	NOVEMBER 2024
Scale	AS SHOWN
Sheet Number	<b>C505</b>
Project Number	2271.010.001

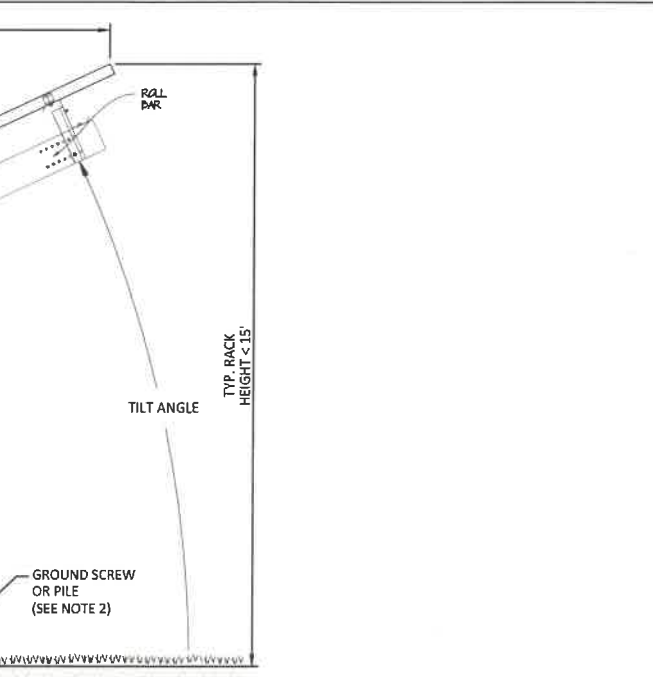

**1** LEVEL SPREADER  
 C505 NOT TO SCALE

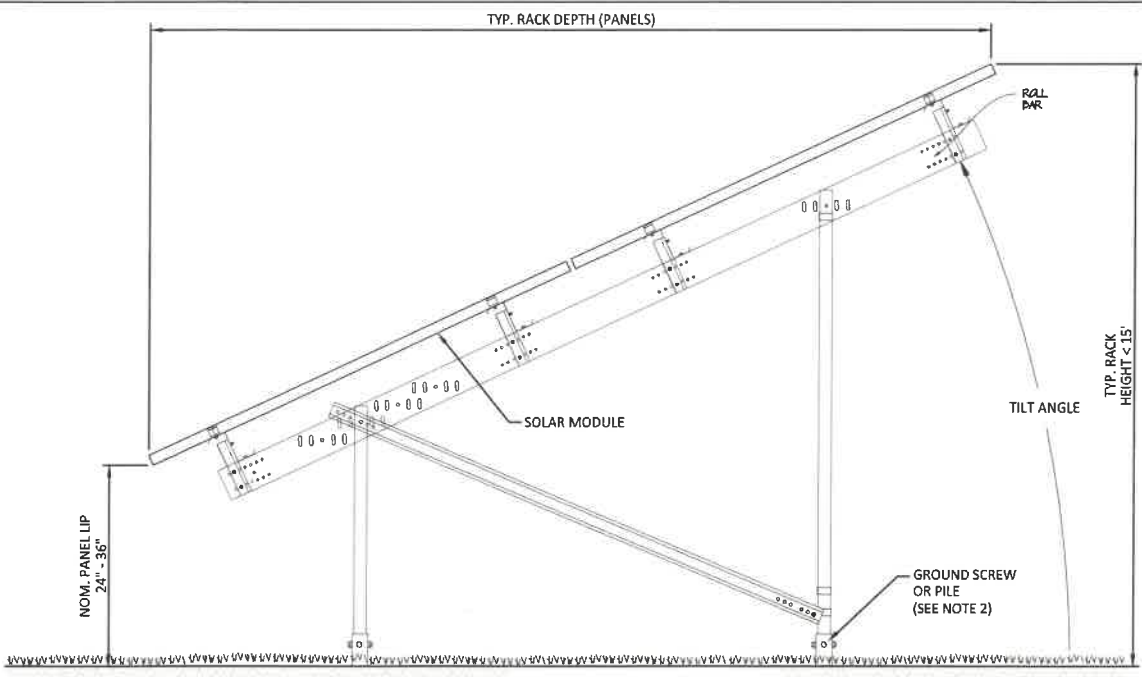

- NOTES:**
- SOLAR MODULE AND FRAME PROFILE FOR SITE PLAN APPROVAL PURPOSES ONLY.
  - FINAL SOLAR MODULE AND FRAME ANCHORING DESIGN WILL BE DEPENDENT ON GEOTECHNICAL INVESTIGATIONS.

**4** SOLAR MODULE AND FRAME PROFILE VIEW  
 C505 NOT TO SCALE

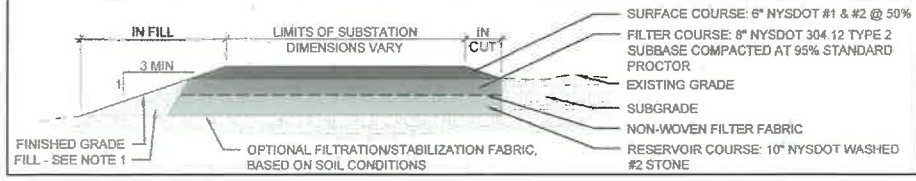

- NOTES:**
- ALL FILL USED FOR SIDE SLOPES SHALL BE ONSITE MATERIAL FROM AREA CUT TO CREATE THE EQUIPMENT PAD OR SHALL BE OFFSITE FILL COMPACTED TO HAVE AN INFILTRATION RATE LESS THAN THE EQUIPMENT PAD SUBGRADE.
  - INFILTRATION TESTING SHALL BE COMPLETED AS REQUIRED BY APPENDIX D OF THE MOST CURRENT NYS STORMWATER MANAGEMENT DESIGN MANUAL, OR AS APPROVED BY THE NYS DEC REGIONAL OFFICE.
  - THIS SECTION SHALL BE APPLICABLE TO MEET THE STORMWATER MANAGEMENT REQUIREMENTS OF NEW DEVELOPMENT PER THE MOST CURRENT NYS STORMWATER MANAGEMENT DESIGN MANUAL, FOR SITES WITH INFILTRATION RATES OF GREATER THAN OR EQUAL TO 0.5 INCHES PER HOUR.

**2** EQUIPMENT PAD SECTION - INFILTRATION RATE  $\geq$  0.5 IN/HR  
 C505 NOT TO SCALE

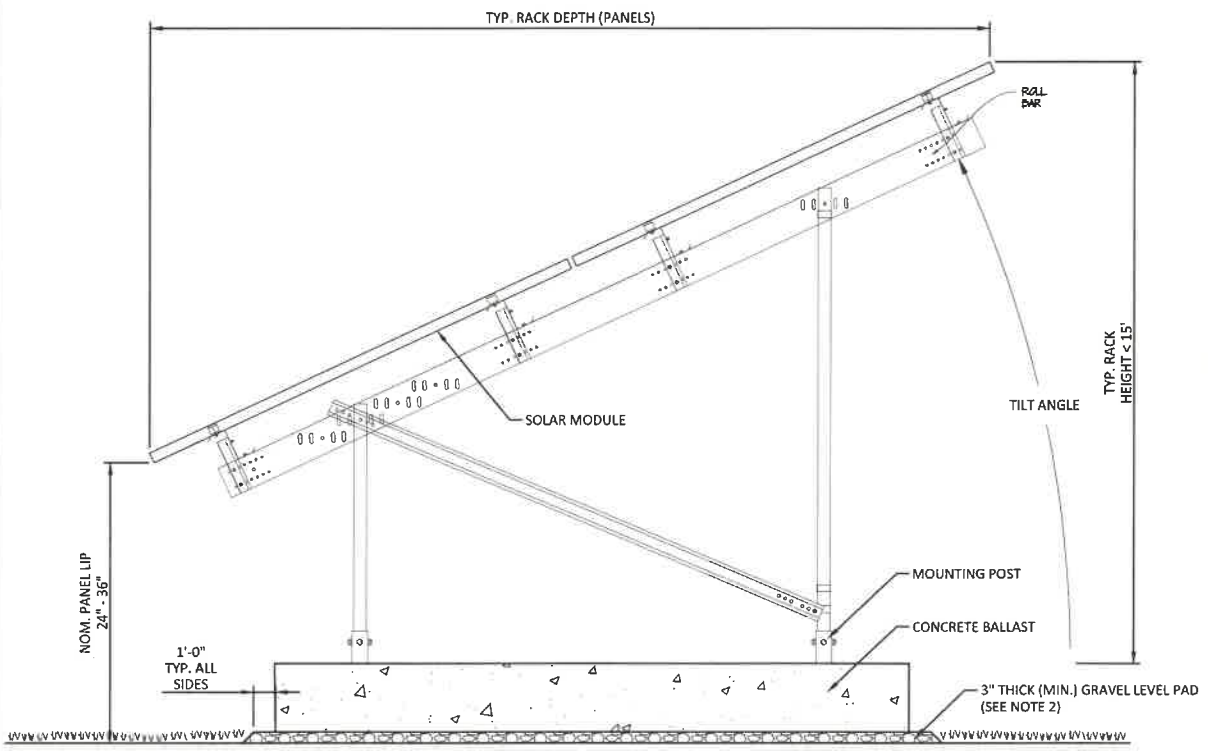

- NOTES:**
- SOLAR MODULE AND FRAME PROFILE FOR SITE PLAN APPROVAL PURPOSES ONLY.
  - PARAMETERS FOR ADDITIONAL GRAVEL FOR SETTLING BALLAST:
    - SLOPE  $\leq$  5%, NONE REQUIRED
    - 5% < SLOPE  $\leq$  10%, AS REQUIRED TO LEVEL UNDULATING SLOPES
    - SLOPE > 10%, LEVELING PAD REQUIRED

**5** BALLASTED SOLAR MODULE AND FRAME PROFILE VIEW  
 C505 NOT TO SCALE

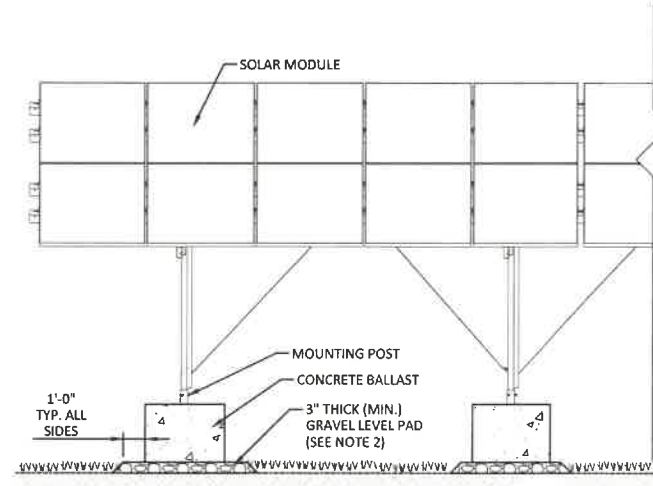

- NOTES:**
- SOLAR MODULE AND FRAME PROFILE FOR SITE PLAN APPROVAL PURPOSES ONLY.
  - PARAMETERS FOR ADDITIONAL GRAVEL FOR SETTLING BALLAST:
    - SLOPE  $\leq$  5%, NONE REQUIRED
    - 5% < SLOPE  $\leq$  10%, AS REQUIRED TO LEVEL UNDULATING SLOPES
    - SLOPE > 10%, LEVELING PAD REQUIRED

**6** BALLASTED SOLAR MODULE AND FRAME ELEVATION VIEW  
 C505 NOT TO SCALE

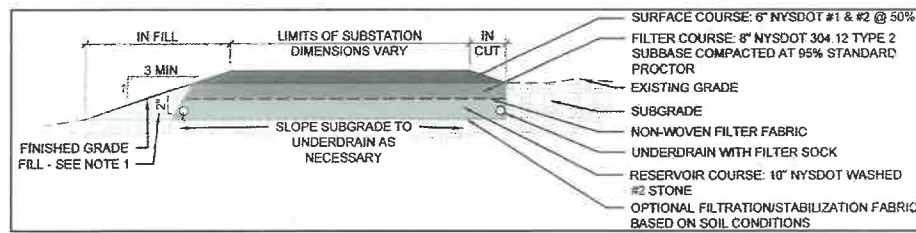

- NOTES:**
- ALL FILL USED FOR SIDE SLOPES SHALL BE ONSITE MATERIAL FROM AREA CUT TO CREATE THE EQUIPMENT PAD OR SHALL BE OFFSITE FILL COMPACTED TO HAVE AN INFILTRATION RATE LESS THAN THE EQUIPMENT PAD SUBGRADE.
  - UNDERDRAIN SIZE AND LAYOUT WILL VARY DEPENDING ON THE SIZE OF THE EQUIPMENT PAD.
  - UNDERDRAIN WILL DAYLIGHT AND DISCHARGE TO A LEVEL SPREADER THEN A VEGETATED FILTER STRIP OR RIPARIAN FOREST BUFFER TO MEET RUNOFF REDUCTION VOLUME REQUIREMENTS.
  - LEVEL SPREADER SHALL BE DESIGNED PER THE MOST CURRENT NYS STANDARDS AND SPECIFICATIONS FOR EROSION AND SEDIMENT CONTROL TO CREATE SHEET FLOW PRIOR TO DISCHARGE TO THE VEGETATED FILTER STRIP OR RIPARIAN FOREST BUFFER.
  - THIS SECTION SHALL BE APPLICABLE TO MEET THE STORMWATER MANAGEMENT REQUIREMENTS OF NEW DEVELOPMENT PER THE MOST CURRENT NYS STORMWATER MANAGEMENT DESIGN MANUAL, FOR SITES WITH INFILTRATION RATES OF GREATER THAN OR EQUAL TO 0.5 INCHES PER HOUR.

**3** EQUIPMENT PAD SECTION - INFILTRATION RATE < 0.5 IN/HR  
 C505 NOT TO SCALE

**REVIEW ONLY NOT FOR CONSTRUCTION**

Plotted: Nov 26, 2024 - 4:19PM  
 i:\Projects\2200\2271.010.001\C500 Site Details.dwg  
 Drawn by: KJK  
 Checked by: BAKM  
 Designed by: KJK  
 In charge of: CAW

IT IS A VIOLATION OF THE NEW YORK STATE EDUCATION LAW, ARTICLE 145 § 7209 SPECIAL PROVISIONS, FOR ANY PERSON, UNLESS THEY ARE ACTING UNDER THE DIRECTION OF A LICENSED PROFESSIONAL ENGINEER, ARCHITECT, LANDSCAPE ARCHITECT, OR LAND SURVEYOR TO ALTER AN ITEM IN ANY WAY. IF AN ITEM BEARING THE STAMP OF A LICENSED PROFESSIONAL IS ALTERED, THE ALTERING PROFESSIONAL SHALL STAMP THE DOCUMENT AND INCLUDE THE NOTATION "ALTERED BY" FOLLOWED BY THEIR SIGNATURE, THE DATE OF SUCH ALTERATION, AND A SPECIFIC DESCRIPTION OF THE ALTERATION.

REVISIONS

SUNN LLC  
 JORDAN ROAD SOLAR ENERGY SYSTEM  
**SUBDIVISION PLAN**  
 ONONDAGA COUNTY, NEW YORK

443 Electronics Parkway  
 Liverpool, NY  
 13088  
**Barton & Loguidice, D.P.C.**

REVIEW ONLY  
 NOT FOR  
 CONSTRUCTION

Date  
 NOVEMBER 2024  
 Scale  
 AS SHOWN  
 Sheet Number  
**C002**  
 Project Number  
 2271.010.001

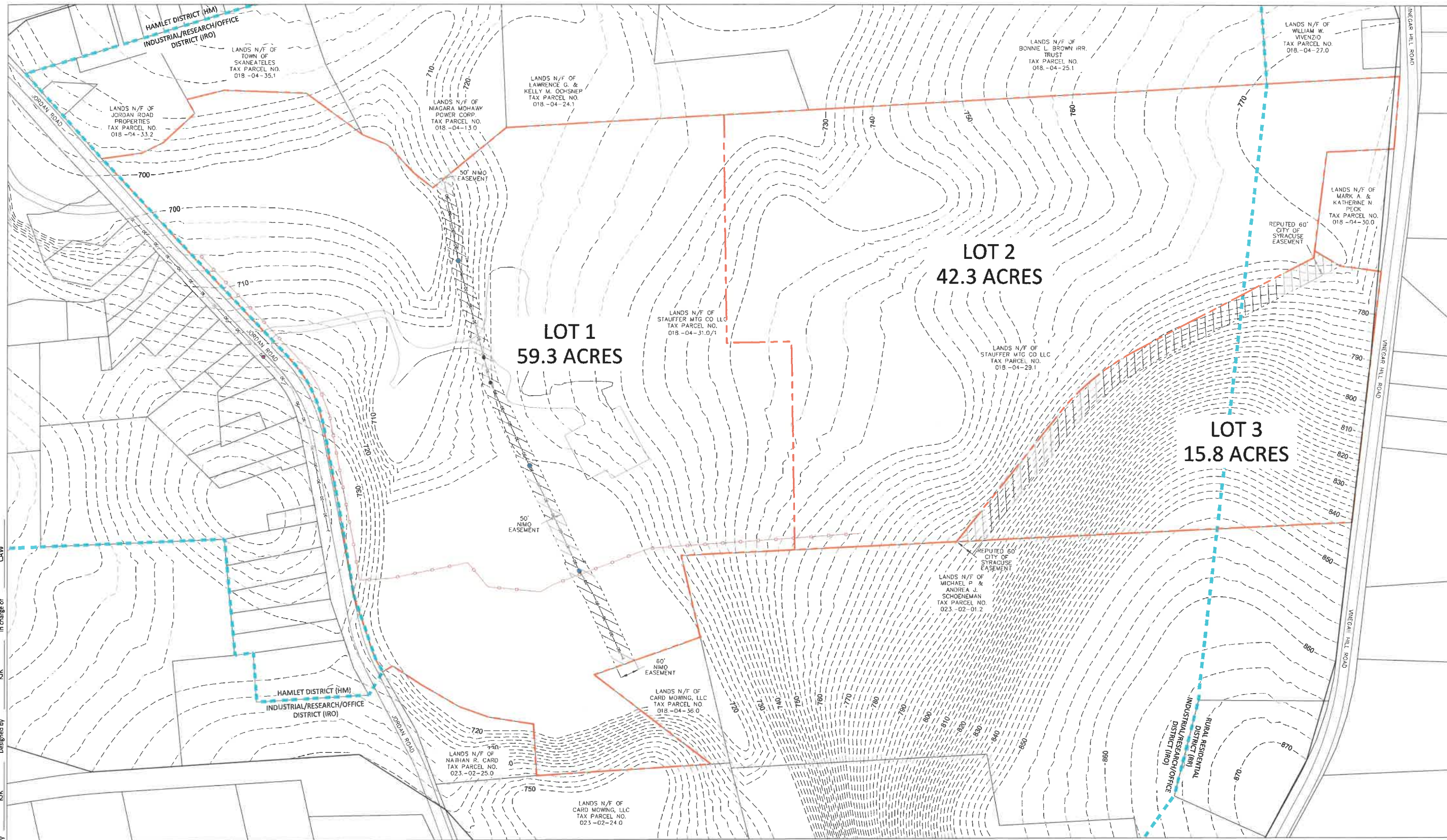

**LOT 1**

REGULATION	REQUIREMENT	PROPOSED
LOT SIZE MINIMUM	2 ACRES	59.3 ACRES
LOT FRONTAGE MINIMUM	300 FT	1,871 FT
FRONT YARD MINIMUM	60 FT	100 FT
SIDE YARD MINIMUM	50 FT	100 FT
REAR YARD MINIMUM	100 FT	20 FT
LOT COVERAGE MAXIMUM	50%	37%
IMPERMEABLE COVERAGE MAXIMUM	40%	37%
PARKING LOCATION	BESIDE OR BEHIND	N/A
BUILDING FOOTPRINT MAXIMUM	300,000 SQFT	N/A
BUILDING HEIGHT MAXIMUM	35 FT	15 FT

**LOT 2**

REGULATION	REQUIREMENT	PROPOSED
LOT SIZE MINIMUM	2 ACRES	42.3 ACRES
LOT FRONTAGE MINIMUM	200 FT	225 FT
FRONT YARD MINIMUM	60 FT	100 FT
SIDE YARD MINIMUM	60 FT	115 FT
REAR YARD MINIMUM	100 FT	20 FT
LOT COVERAGE MAXIMUM	50%	34%
IMPERMEABLE COVERAGE MAXIMUM	40%	34%
PARKING LOCATION	BESIDE OR BEHIND	N/A
BUILDING FOOTPRINT MAXIMUM	300,000 SQFT	N/A
BUILDING HEIGHT MAXIMUM	35 FT	15 FT

**LOT 3**



REGULATION	REQUIREMENT	PROPOSED
LOT SIZE MINIMUM	2 ACRES	15.8 ACRES
LOT FRONTAGE MINIMUM	200 FT	781 FT
FRONT YARD MINIMUM	60 FT	100 FT
SIDE YARD MINIMUM	60 FT	100 FT
REAR YARD MINIMUM	100 FT	107 FT
LOT COVERAGE MAXIMUM	50%	29%
IMPERMEABLE COVERAGE MAXIMUM	40%	29%
PARKING LOCATION	BESIDE OR BEHIND	N/A
BUILDING FOOTPRINT MAXIMUM	300,000 SQFT	N/A
BUILDING HEIGHT MAXIMUM	35 FT	15 FT

**REVIEW ONLY NOT FOR CONSTRUCTION**

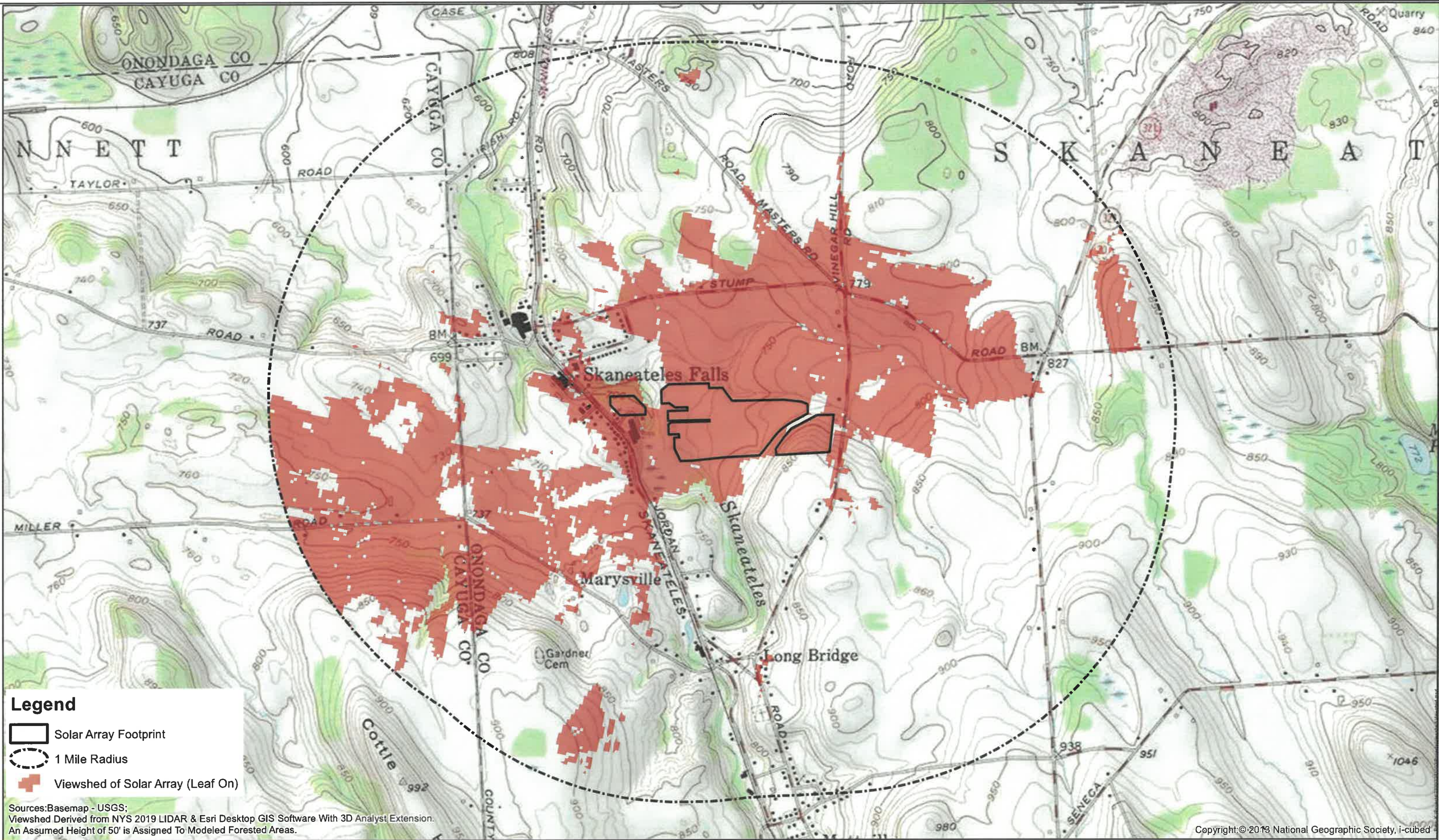

Nov 27, 2024 - 3:18PM  
 SYR BJK mlb/its  
 \\officerv\cad\Projects\2200\2271.010.001\2271.010.001 Site Layout Sheets.dwg  
 Checked by: BAKM  
 Drawn by: KIK  
 Designed by: KIK  
 In charge of: CAW



- Legend**
-  Solar Array Footprint
  -  1 Mile Radius
  -  Viewshed of Solar Array (Leaf On)

Sources: Basemap - USGS;  
 Viewshed Derived from NYS 2019 LIDAR & Esri Desktop GIS Software With 3D Analyst Extension.  
 An Assumed Height of 50' is Assigned To Modeled Forested Areas.



Copyright: © 2013 National Geographic Society, i-cubed

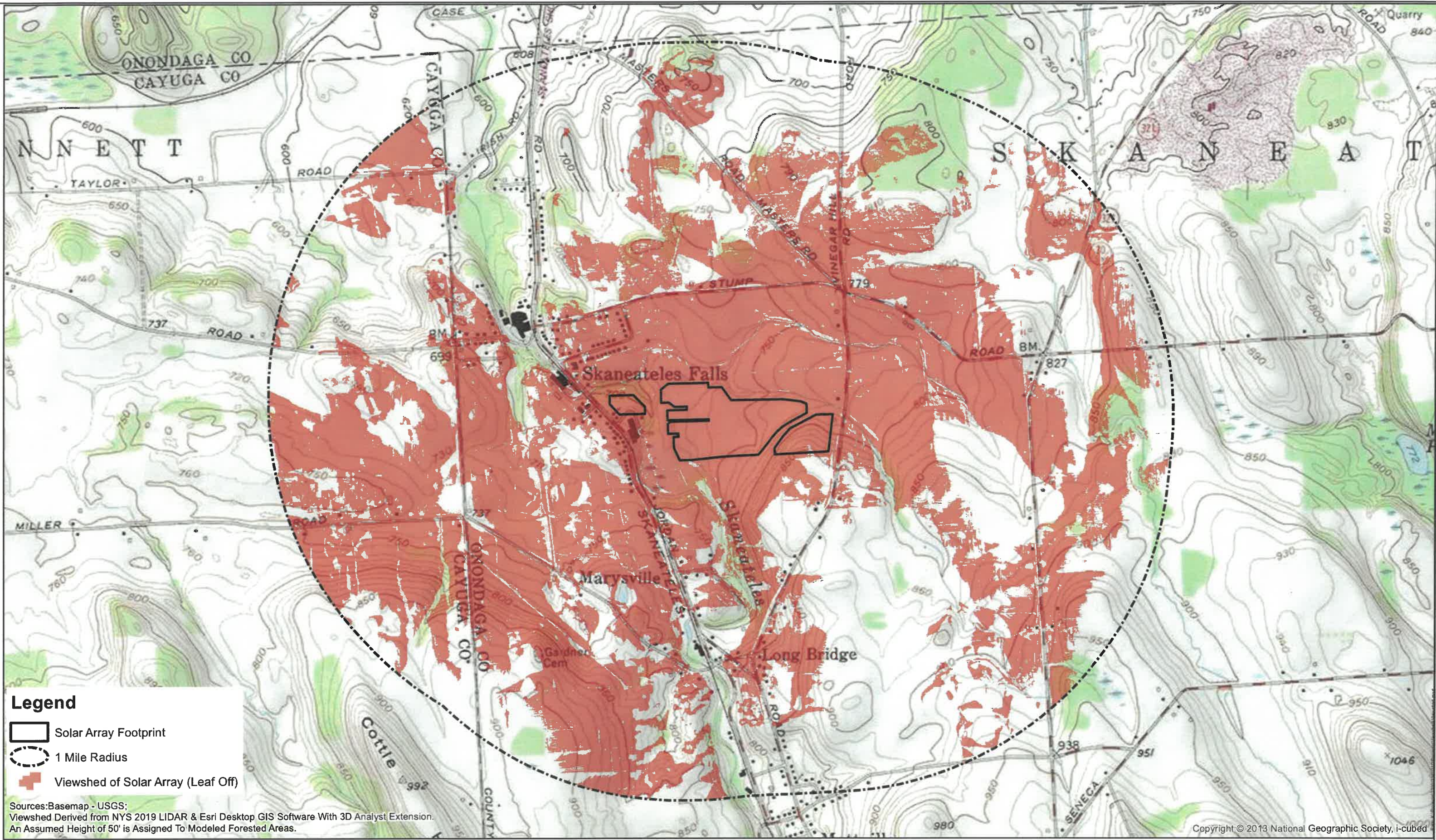

  
 1 inch = 1,350 feet

Abundant Solar Power, LLC		Figure 1
<b>Solar Array Leaf On Viewshed</b>		Project No.
Onondaga County	11/26/2024	New York 2271.010.001



- Legend**
-  Solar Array Footprint
  -  1 Mile Radius
  -  Viewshed of Solar Array (Leaf Off)

Sources: Basemap - USGS;  
 Viewshed Derived from NYS 2019 LIDAR & Esri Desktop GIS Software With 3D Analyst Extension.  
 An Assumed Height of 50' is Assigned To Modeled Forested Areas.

Copyright © 2013 National Geographic Society, i-cubed

IT IS A VIOLATION OF THE NEW YORK STATE EDUCATION LAW, ARTICLE 145 § 7209 SPECIAL PROVISIONS, FOR ANY PERSON, UNLESS THEY ARE ACTING UNDER THE DIRECTION OF A LICENSED PROFESSIONAL ENGINEER, ARCHITECT, LANDSCAPE ARCHITECT, OR LAND SURVEYOR, TO ALTER AN ITEM IN ANY WAY. IF AN ITEM BEARING THE STAMP OF A LICENSED PROFESSIONAL IS ALTERED, THE ALTERING PROFESSIONAL SHALL STAMP THE DOCUMENT AND INCLUDE THE NOTATION "ALTERED BY" FOLLOWED BY THEIR SIGNATURE, THE DATE OF SUCH ALTERATION, AND A SPECIFIC DESCRIPTION OF THE ALTERATION.

REVISIONS

SUNN LLC  
 JORDAN ROAD SOLAR ENERGY SYSTEM  
 ONONDAGA COUNTY, NEW YORK  
 TOWN OF SKANEATELES

**B&L**  
 443 Electronics Parkway  
 Liverpool, NY  
 13088  
**Barton & Loguidice, D.P.C.**



Date: OCTOBER 2024  
 Scale: AS SHOWN  
 Sheet Number: C101  
 Project Number: 2271.010.001

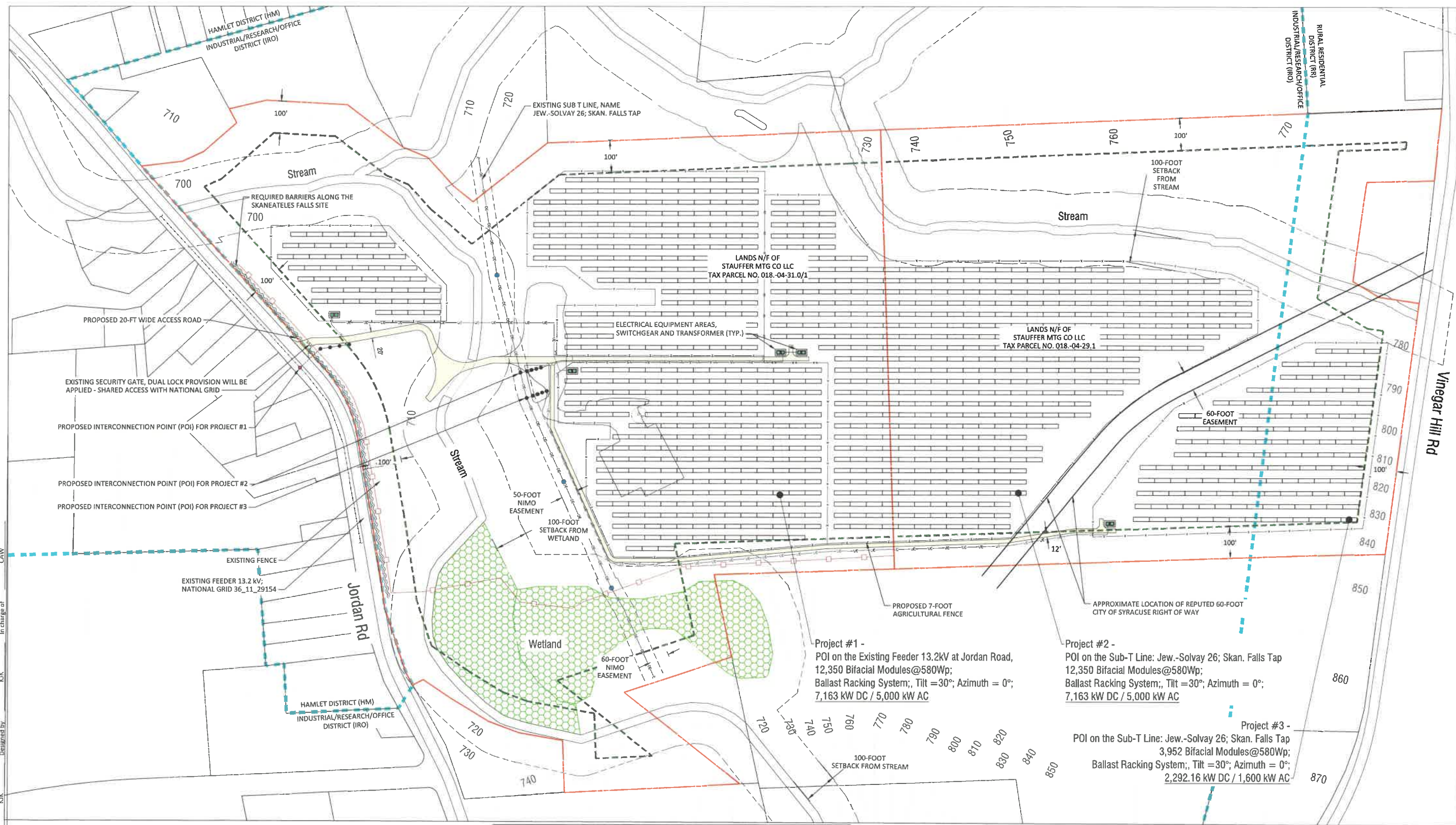

**REVIEW ONLY NOT FOR CONSTRUCTION**



Plotted: Oct 28, 2024 - 3:57PM  
 C:\Users\kibling\OneDrive\Temp\kibling\Local\Temp\kibling\Local\24300\2271.010.001 Site Layout Sheets.dwg  
 Designed by: KIK  
 Drawn by: KIK  
 Checked by: RAM  
 In charge of: CAW